



Prices effective February 5, 2018

Ethospace® System

10-Day or Less

Introduction	page 2
Ethospace® System 10-Day or Less	3
Walls	5
Work Surfaces	44
Wall-Attached Storage	58
Lighting	70
Indices	73
By Name	73
By Number	75
Appendices	
10-Day or Less Order Information	
10-Day Keyed-Alike Information	
Proprietary Textiles Application Chart - 10-Day Workspaces	
Proprietary Textile Colors - 10-Day Workspaces	
For the latest materials information, refer to the Materials pages on HermanMiller.com.	

Introduction

A Note on the Organization of This Book

There are a few signals that will help you understand the organization of this book. Once you know them, you should be able to find your way around easily.

Like a newspaper, this book is formatted with columns of text and illustrations that run vertically.

Information wraps from one column to the next and continues for as many pages as it needs to.

Black bars are clues.

A black bar at the top of a page signals the start of information about a product.

Specification Information, which always begins at the top of a column, includes a series of steps. Each step represents a decision you need to make in order to complete your product number. Steps must be followed sequentially. The number of pages needed to complete information on a product varies; some will be complete in one page; others may fill three or four pages. Just continue going through the steps until you run into the next product, signaled by the black bar at the top of the page.

Black tabs running along the outside edge of the page help you locate what section you are in or what section you want to go to. You can thumb forwards or backwards to find a section; tabs and text appear on both sides of the page.

The additional pages in the back of the book include the appendices and indices. They are signaled by a long black bar running along the outside edge of the page.

The index is presented two ways.

The first index is in alphabetical order by product name. It can be helpful if you are new to the products and numbering scheme or if you are looking for a type of product, such as work chair or round table.

The second index is by product number. It lists, in alphanumeric order, the base product number, typically a five-digit number.

General Information

This book is effective February 5, 2018, subject to change without notice. Products may be purchased from authorized Herman Miller dealers who will quote prices upon request. For more information about our products and services or to see a list of dealers, visit www.HermanMiller.com.

All prices are list prices. Additional services, such as planning services, design, storage, and installation, are not included and must be added to these prices when the additional services are requested.

Illustrations, specifications, and prices are based on the latest information at the time of publication. The right is reserved to make changes at any time without notice in prices, fabrics, finishes, materials, specifications, and models, and also to discontinue models and finishes.

For additional product information such as dimensional drawings and product descriptions, refer to the standard price books.

Service problems are normally handled by a Herman Miller authorized dealer. Where this cannot be accomplished on a local level, service problems should be referred to the Customer Care Representative for your region, Herman Miller, Inc., Zeeland, Michigan 49464.

Walls

Work Surfaces

Storage

Lighting



Bare Frame

E1109.

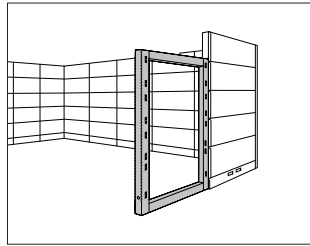

Specification Information

Step 1.

E1109.

Step 2. Height

30	30" high
38	38" high
46	46" high
54	54" high
62	62" high
70	70" high
86	86" high

Step 3. Width

24X	24" wide
30X	30" wide
36X	36" wide
42X	42" wide
48X	48" wide

Prices for Steps 1-3.

	24X	30X	36X	42X	48X
E1109. 30	\$187	197	208	226	255
38	\$215	236	246	262	271
46	\$232	255	266	270	274
54	\$257	274	294	302	324
62	\$271	290	308	320	336
70	\$296	318	328	340	363
86	\$325	350	363	376	399

Frame

E1109.

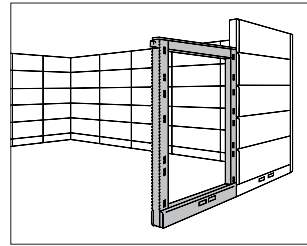

Specification Information

Step 1.

E1109.

Step 2. Height

30	30" high
38	38" high
46	46" high
54	54" high
62	62" high
70	70" high
86	86" high

Step 3. Width

24	24" wide
30	30" wide
36	36" wide
42	42" wide
48	48" wide

Step 4. Power

For 30" high (30) with 24" wide (24) or 30" wide (30)

N	(N) nonpowered with no receptacle locations
R	(R) nonpowered with 1 receptacle location per side (meets Chicago electrical code requirements)
J	(J) nonpowered with 2 receptacle and 1 communication port locations per side
G	(G) 4-circuit power with 2 receptacle and 1 communication port locations per side

For 38" high (38), 46" high (46), 54" high (54), 62" high (62), 70" high (70), or 86" high (86) with 24" wide (24) or 30" wide (30)

N	(N) nonpowered with no receptacle locations
R	(R) nonpowered with 1 receptacle location per side (meets Chicago electrical code requirements)
J	(J) nonpowered with 2 receptacle and 1 communication port locations per side
G	(G) 4-circuit power with 2 receptacle and 1 communication port locations per side

For 38" high (38), 46" high (46), 54" high (54), 62" high (62), 70" high (70), or 86" high (86) with 36" wide (36), 42" wide (42), or 48" wide (48)

N	(N) nonpowered with no receptacle locations
R	(R) nonpowered with 2 receptacle locations per side (meets Chicago electrical code requirements)
J	(J) nonpowered with 2 receptacle and 1 communication port locations per side
G	(G) 4-circuit power with 2 receptacle and 1 communication port locations per side

For 30" high (30) with 36" wide (36), 42" wide (42), or 48" wide (48)

N	(N) nonpowered with no receptacle locations
R	(R) nonpowered with 2 receptacle locations per side (meets Chicago electrical code requirements)
J	(J) nonpowered with 2 receptacle and 1 communication port locations per side
G	(G) 4-circuit power with 2 receptacle and 1 communication port locations per side

Prices for Steps 1-4.

	N	R	J	G
E1109. 30 24	\$355	365	365	534
30	\$401	410	410	576
36	\$445	455	455	621
42	\$490	498	498	668
48	\$534	541	541	710
38 24	\$386	392	393	561
30	\$429	437	437	609
36	\$473	484	484	651
42	\$519	529	529	697
48	\$561	571	571	740
46 24	\$416	424	425	593
30	\$462	469	469	638
36	\$506	512	512	683
42	\$549	558	558	726
48	\$593	602	602	771
54 24	\$444	452	453	620
30	\$489	495	495	666
36	\$534	541	541	710
42	\$576	587	587	754
48	\$620	630	630	798
62 24	\$472	482	482	649
30	\$510	525	527	695
36	\$561	571	571	740
42	\$609	615	615	782
48	\$649	658	658	827

70 24	\$503	509	509	678
30	\$546	554	554	723
36	\$591	600	600	769
42	\$635	643	643	811
48	\$678	688	688	853
86 24	\$559	569	569	738
30	\$605	613	613	779
36	\$648	656	656	826
42	\$693	701	701	869
48	\$738	744	744	913

Step 5. Top Cap Finish

NN	none	+\$0
BU	black umber	+\$14
HF	inner tone light	+\$14
LU	soft white	+\$14
MT	medium tone	+\$14
CN	metallic champagne	+\$0

Step 6. Cable Management Finish

BU	black umber	+\$0
HF	inner tone light	+\$0
HT	inner tone	+\$0
LU	soft white	+\$0
MT	medium tone	+\$0

Frame, Transaction Work Surface E1116.

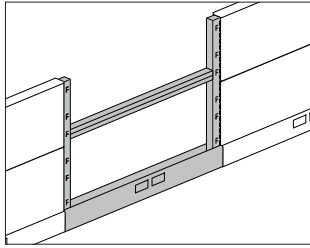

Specification Information

Step 1.

E1116.38

Step 2. Width

- 36** 36" wide
- 48** 48" wide
- 60** 60" wide

Step 3. Power

- N** (N) nonpowered with no receptacle locations
- J** (J) nonpowered with 2 to 4 receptacle and 1 to 2 communication port locations per side
- G** (G) 4-circuit power with 2 to 4 receptacle and 1 to 2 communication port locations per side

Prices for Steps 1-3.

		N	J	G
E1116.38	36	\$688	697	879
	48	\$772	779	950
	60	\$1199	1207	1376

Step 4. Cable Management Finish

- BU** black umber +\$0
- HF** inner tone light +\$0
- LU** soft white +\$0
- MT** medium tone +\$0

Stile Covers and Top Caps, Transaction Work Surface Frame E1117.

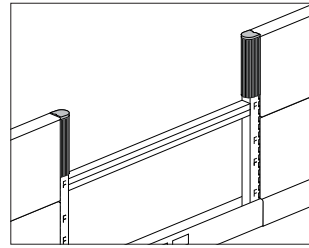

Specification Information

Step 1.

E1117.

Step 2. Type

- S** standard
- A** architectural

Prices for Steps 1-2.

E1117. S	\$106
A	\$438

Step 3. Finish

For standard (S)

8Q folkstone grey	+\$0
91 white	+\$0
BU black umber	+\$0
CL cool grey neutral	+\$0
HF inner tone light	+\$0
LU soft white	+\$0
MT medium tone	+\$0
SG slate grey	+\$0
WL sandstone	+\$0
WN warm grey neutral	+\$0

For architectural (A)

8Q folkstone grey	+\$0
91 white	+\$0
BU black umber	+\$0
CN metallic champagne	+\$0
EH metallic bronze	+\$0
HF inner tone light	+\$0
LU soft white	+\$0
MS metallic silver	+\$0
MT medium tone	+\$0
SG slate grey	+\$0
WL sandstone	+\$0

Side Cover

E1263.
E1264.

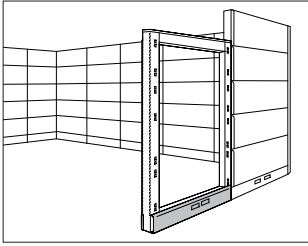

Ethospace® Walls

Specification Information

Step 1.

E126

Step 2. Base Type

- 3. plain base
- 4. grooved base

Step 3. Width

- 24** 24" wide
- 30** 30" wide
- 36** 36" wide
- 42** 42" wide
- 48** 48" wide

Step 4. Receptacle/Data Locations

For plain base (3.) with 24" wide (24) or 30" wide (30)

- N** (N) no receptacle locations
- J** (J) 2 receptacle and 1 communication port locations
- R** (R) 1 receptacle location (meets Chicago electrical code requirements)

For plain base (3.) with 36" wide (36), 42" wide (42), or 48" wide (48)

- N** (N) no receptacle locations
- J** (J) 2 receptacle and 1 communication port locations
- R** (R) 2 receptacle locations (meets Chicago electrical code requirements)

For grooved base (4.) with 24" wide (24) or 30" wide (30)

- N** (N) no receptacle locations
- R** (R) 1 receptacle location (meets Chicago electrical code requirements)

For grooved base (4.) with 36" wide (36), 42" wide (42), or 48" wide (48)

- N** (N) no receptacle locations
- R** (R) 2 receptacle locations (meets Chicago electrical code requirements)

Prices for Steps 1-4.

	N	J	R
E1263. 24	\$59	63	72
30	\$63	68	91
36	\$71	77	97
42	\$80	87	102
48	\$86	93	115

E1264. 24	\$61	—	76
30	\$65	—	95
36	\$75	—	100
42	\$82	—	106
48	\$88	—	119

Step 5. Surface Finish

For plain base (3.)

BU black umber	+\$0
HF inner tone light	+\$0
HT inner tone	+\$0
LU soft white	+\$0
MT medium tone	+\$0

For grooved base (4.)

BU black umber	+\$0
HF inner tone light	+\$0
LU soft white	+\$0
MT medium tone	+\$0

Stacking Frame

E1112.

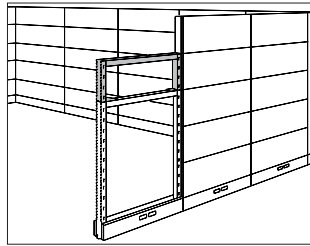

Specification Information

Step 1.

E1112.

Step 2. Width

24	24" wide
30	30" wide
36	36" wide
42	42" wide
48	48" wide

Prices for Steps 1-2.

E1112. 24	\$234
30	\$248
36	\$256
42	\$266
48	\$274

Draw Rod

E1120.

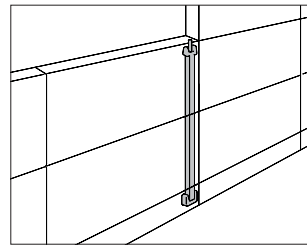

Specification Information

Step 1.

E1120.

Step 2. Height

30	30" high
38	38" high
46	46" high
54	54" high
62	62" high
70	70" high
86	86" high

Prices for Steps 1-2.

E1120. 30	\$29
38	\$29
46	\$30
54	\$30
62	\$34
70	\$36
86	\$37

Wall Strip

E1130.

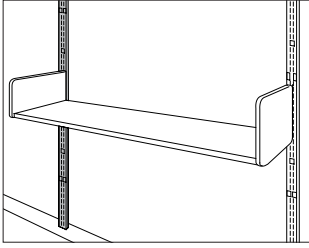

Tile Adapter

E1131.

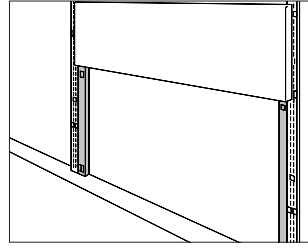

Ethospace® Walls

Specification Information

Step 1.

E1130.

Step 2. Height

64N 64" high

80N 80" high

Prices for Steps 1-2.

E1130. 64N	\$73
80N	\$79

Specification Information

Step 1.

E1131.

Step 2. Height

08 8" high

16 16" high

Prices for Steps 1-2.

E1131. 08	\$32
16	\$53

Wall Fastener

X1192.

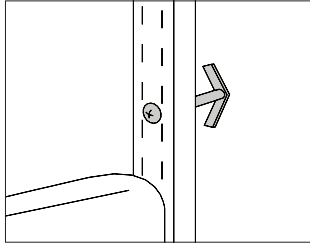

Specification Information

Step 1.

X1192.

Step 2. Size

- 1** no. 10, 1½" sheet metal screw
- 2** no. 10, 3" sheet metal screw
- 3** no. 10, 3" machine screw

Prices for Steps 1-2.

X1192. 1	\$32
2	\$32
3	\$55

Trim Strip

E1132.

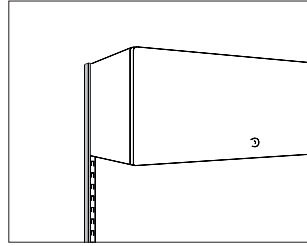

Specification Information

Step 1.

E1132.

Step 2. Height

- 64** 64" high
- 80** 80" high

Prices for Steps 1-2.

E1132. 64	\$80
80	\$97

Step 3. Surface Finish

BU	black umber	+\$0
HF	inner tone light	+\$0
LU	soft white	+\$0
MT	medium tone	+\$0

Wall Start

E1210.

Wall Start Filler

E1212.

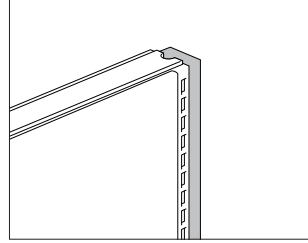
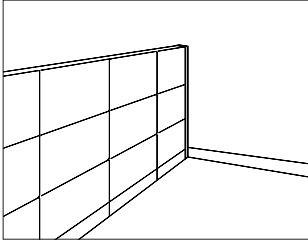

Ethospace® Walls

Specification Information

Step 1.

E1210.

Step 2. Height

- 30** 30" high
- 38** 38" high
- 46** 46" high
- 54** 54" high
- 62** 62" high
- 70** 70" high
- 86** 86" high

Prices for Steps 1-2.

E1210. 30	\$182
38	\$188
46	\$189
54	\$191
62	\$209
70	\$217
86	\$237

Step 3. Surface Finish

BU	black umber	+\$0
HF	inner tone light	+\$0
LU	soft white	+\$0
MT	medium tone	+\$0
CN	metallic champagne	+\$0

Specification Information

Step 1.

E1212.70

\$155

2-Way 90° Connector

E1220.

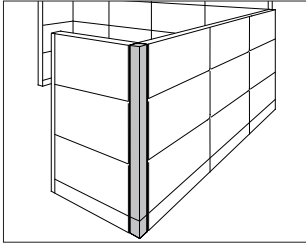

Specification Information

Step 1.

E1220.

Step 2. Height

30	30" high
38	38" high
46	46" high
54	54" high
62	62" high
70	70" high
86	86" high

Step 3. Surface Material

S	vinyl
F	fabric

Step 4. Shape

R	radius
S	square

Step 5. Power

N	(N) nonpowered
E	(E) powered

Prices for Steps 1-5.

	RN	RE	SN	SE
E1220. 30 S	\$233	276	246	285
F	\$225	263	230	270
38 S	\$255	296	265	306
F	\$236	276	251	287
46 S	\$272	315	284	323
F	\$257	296	270	311
54 S	\$290	334	306	346
F	\$273	314	286	327
62 S	\$307	350	319	357
F	\$286	327	303	342
70 S	\$319	360	335	376
F	\$298	338	314	353
86 S	\$357	402	377	416
F	\$337	377	353	392

Step 6. Surface Finish

For vinyl (S)

See application chart and textiles list for fabric usage and numbers. First 2 digits of number indicate fabric line; remaining digit(s) indicate fabric color.

Thermoplastic-Textured Surface

BU	black umber	+\$0
HF	inner tone light	+\$0
HT	inner tone	+\$0
LU	soft white	+\$0
MT	medium tone	+\$0

Step 7. Top Cap Finish

BU	black umber	+\$0
HF	inner tone light	+\$0
LU	soft white	+\$0
MT	medium tone	+\$0

Step 8. Cable Management Finish

BU	black umber	+\$0
HF	inner tone light	+\$0
HT	inner tone	+\$0
LU	soft white	+\$0
MT	medium tone	+\$0

Step 9. Surface Finish

For fabric (F)

See application chart and textiles list for fabric usage and numbers. First 2 digits of number indicate fabric line; remaining digit(s) indicate fabric color.

Price Category 1	+\$0
Price Category 2	+\$5
Price Category 3	+\$15
Price Category 4	+\$22

2-Way 90° Connector, Monolithic E1224.

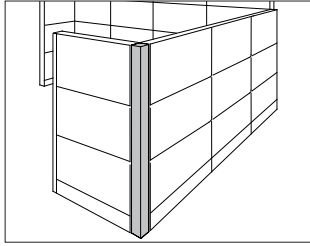

Spacer E1222.

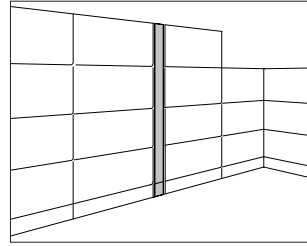

Ethospace® Walls

Specification Information

Step 1.
E1224.

Step 2. Height

30	30" high
38	38" high
46	46" high
54	54" high
62	62" high
70	70" high
86	86" high

Step 3. Surface Material

SS vinyl

Step 4. Power

N (N) nonpowered
E (E) powered

Prices for Steps 1-4.

	N	E
E1224. 30 SS	\$246	285
38 SS	\$265	306
46 SS	\$284	323
54 SS	\$306	346
62 SS	\$319	357
70 SS	\$335	376
86 SS	\$377	416

Step 5. Surface Finish

Thermoplastic-Textured Surface

BU	black umber	+\$0
HF	inner tone light	+\$0
LU	soft white	+\$0
MT	medium tone	+\$0

Step 6. Top Cap Finish

BU	black umber	+\$0
HF	inner tone light	+\$0
LU	soft white	+\$0
MT	medium tone	+\$0

Specification Information

Step 1.
E1222.

Step 2. Height

30	30" high
38	38" high
46	46" high
54	54" high
62	62" high
70	70" high
86	86" high

Step 3. Surface Material

S vinyl
F fabric

Step 4. Power

N (N) nonpowered
E (E) powered

Prices for Steps 1-4.

	N	E
E1222. 30 S	\$237	303
F	\$255	295
38 S	\$278	322
F	\$273	316
46 S	\$298	341
F	\$291	334
54 S	\$317	360
F	\$311	352
62 S	\$333	375
F	\$323	365
70 S	\$343	388
F	\$337	380
86 S	\$384	425
F	\$373	417

Step 5. Surface Finish Side 1		
<i>For vinyl (S)</i>		
BU	black umber	+\$0
HF	inner tone light	+\$0
HT	inner tone	+\$0
LU	soft white	+\$0
MT	medium tone	+\$0
SG	slate grey	+\$0
WL	sandstone	+\$0
WN	warm grey neutral	+\$0

Step 6. Surface Finish Side 2		
<i>For vinyl (S)</i>		
BU	black umber	+\$0
HF	inner tone light	+\$0
HT	inner tone	+\$0
LU	soft white	+\$0
MT	medium tone	+\$0

Step 7. Top Cap Finish		
<i>For vinyl (S) or fabric (F)</i>		
BU	black umber	+\$0
HF	inner tone light	+\$0
LU	soft white	+\$0
MT	medium tone	+\$0

Step 8. Cable Management Finish		
BU	black umber	+\$0
HF	inner tone light	+\$0
HT	inner tone	+\$0
LU	soft white	+\$0
MT	medium tone	+\$0

Step 9. Surface Finish Side 1		
<i>For fabric (F)</i>		
<i>See application chart and textiles list for fabric usage and numbers.</i>		
<i>First 2 digits of number indicate fabric line; remaining digit(s) indicate fabric color.</i>		
Price Category 1		+\$0
Price Category 2		+\$4
Price Category 3		+\$9
Price Category 4		+\$13

Step 10. Surface Finish Side 2		
<i>For fabric (F)</i>		
<i>See application chart and textiles list for fabric usage and numbers.</i>		
<i>First 2 digits of number indicate fabric line; remaining digit(s) indicate fabric color.</i>		
Price Category 1		+\$0
Price Category 2		+\$4
Price Category 3		+\$9
Price Category 4		+\$13

3-Way 90° Connector

E1230.

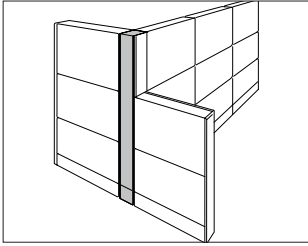

Ethospace® Walls

Specification Information

Step 1.

E1230.

Step 2. Height

30	30" high
38	38" high
46	46" high
54	54" high
62	62" high
70	70" high
86	86" high

Step 3. Surface Material

S	vinyl
F	fabric

Step 4. Power

N	(N) nonpowered
E	(E) powered

Prices for Steps 1-4.

	N	E
E1230. 30 S	\$311	350
F	\$317	355
38 S	\$335	373
F	\$341	380
46 S	\$356	396
F	\$362	402
54 S	\$380	419
F	\$384	423
62 S	\$403	443
F	\$408	448
70 S	\$426	464
F	\$430	469
86 S	\$474	512
F	\$482	518

Step 5. Surface Finish

For vinyl (S)

Thermoplastic-Textured Surface

BU	black umber	+\$0
HF	inner tone light	+\$0
HT	inner tone	+\$0
LU	soft white	+\$0
MT	medium tone	+\$0

Step 6. Top Cap Finish

BU	black umber	+\$0
HF	inner tone light	+\$0
LU	soft white	+\$0
MT	medium tone	+\$0

Step 7. Cable Management Finish

BU	black umber	+\$0
HF	inner tone light	+\$0
HT	inner tone	+\$0
LU	soft white	+\$0
MT	medium tone	+\$0

Step 8. Surface Finish

For fabric (F)

See application chart and textiles list for fabric usage and numbers.

First 2 digits of number indicate fabric line; remaining digit(s) indicate fabric color.

Price Category 1	+\$0
Price Category 2	+\$5
Price Category 3	+\$11
Price Category 4	+\$15

3-Way 90° Connector, Monolithic E1231.

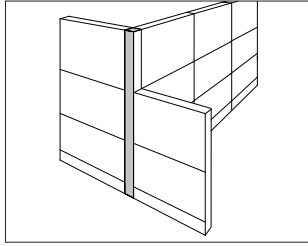

Specification Information

Step 1.

E1231.

Step 2. Height

30S	30" high
38S	38" high
46S	46" high
54S	54" high
62S	62" high
70S	70" high
86S	86" high

Step 3. Power

N	(N) nonpowered
E	(E) powered

Prices for Steps 1-3.

	N	E
E1231. 30S	\$332	368
38S	\$352	388
46S	\$377	415
54S	\$401	436
62S	\$426	463
70S	\$449	486
86S	\$492	538

Step 4. Surface Finish

Thermoplastic-Textured Surface

BU	black umber	+\$0
HF	inner tone light	+\$0
LU	soft white	+\$0
MT	medium tone	+\$0

Step 5. Top Cap Finish

BU	black umber	+\$0
HF	inner tone light	+\$0
LU	soft white	+\$0
MT	medium tone	+\$0

4-Way 90° Connector E1240.

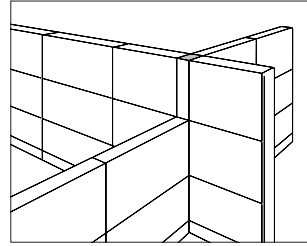

Specification Information

Step 1.

E1240.

Step 2. Height

30F	30" high
38F	38" high
46F	46" high
54F	54" high
62F	62" high
70F	70" high
86F	86" high

Step 3. Power

N	(N) nonpowered
E	(E) powered

Prices for Steps 1-3.

	N	E
E1240. 30F	\$339	390
38F	\$362	414
46F	\$385	438
54F	\$407	462
62F	\$428	483
70F	\$450	504
86F	\$500	558

Step 4. Top Cap Finish

NN	none	+\$0
BU	black umber	+\$0
HF	inner tone light	+\$0
LU	soft white	+\$0
MT	medium tone	+\$0

2-Way 90° Stacking Connector

E1220.

Spacer Stacking Connector

E1222.

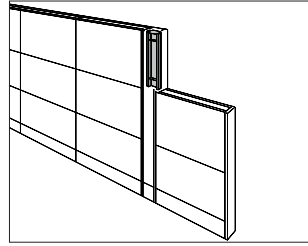
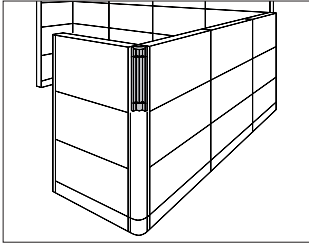

Ethospace® Walls

Specification Information

Step 1.
E1220.16

\$180

Specification Information

Step 1.
E1222.16

\$195

3-Way 90° Stacking Connector

E1230.

4-Way 90° Stacking Connector

E1240.

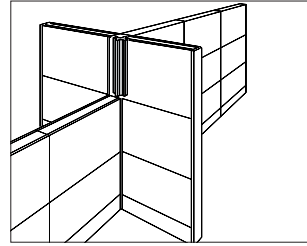
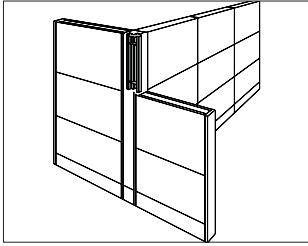

Specification Information

Step 1.

E1230.16

\$191

Specification Information

Step 1.

E1240.16

\$189

Ethospace® Walls

Stacking Frame Hardware Kit,
Change of Height

E1293.
E1294.

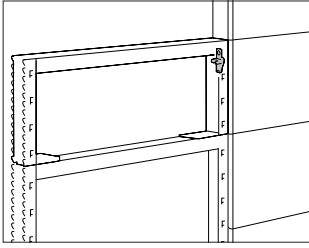

Bare Connector

E1219.

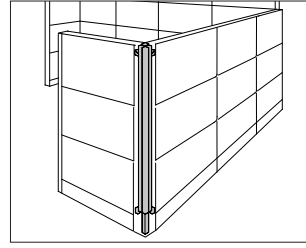

Ethospace® Walls

Specification Information

Step 1.

E129

Step 2. Connector Type

- 3. stacking frame to frame or 2-way 90° or 135° connector
- 4. stacking frame to spacer or 3- or 4-way 90° connector or 2-way 120° connector

Prices for Steps 1-2.

E1293.	\$23
E1294.	\$18

Specification Information

Step 1.

E1219.

Step 2. Height

30	30" high
38	38" high
46	46" high
54	54" high
62	62" high
70	70" high
86	86" high

Step 3. Configuration

- A** 2-way 90° connector with draw rod
- B** spacer
- C** 3-way 90° connector

Prices for Steps 1-3.

		A	B	C
E1219.	30	\$144	181	217
	38	\$157	191	224
	46	\$174	202	236
	54	\$188	214	255
	62	\$201	226	271
	70	\$215	235	289
	86	\$230	245	328

2-Way 90° Connector Cover

E1270.

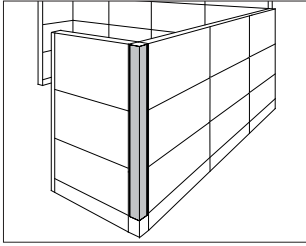

Specification Information

Step 1.

E1270.

Step 2. Height

30	30" high
38	38" high
46	46" high
54	54" high
62	62" high
70	70" high
86	86" high

Step 3. Surface Material

S	vinyl
F	fabric

Step 4. Shape

R	radius
S	square

Prices for Steps 1-4.

	R	S
E1270. 30 S	\$129	129
F	\$136	136
38 S	\$139	139
F	\$143	143
46 S	\$146	146
F	\$151	151
54 S	\$157	157
F	\$161	161
62 S	\$170	170
F	\$174	174
70 S	\$179	179
F	\$182	182
86 S	\$199	199
F	\$200	200

Step 5. Surface Finish

Thermoplastic-Textured Surface

For vinyl (S)

BU	black umber	+\$0
HF	inner tone light	+\$0
HT	inner tone	+\$0
LU	soft white	+\$0
MT	medium tone	+\$0

For fabric (F)

Price Category 1	+\$0
Price Category 2	+\$7
Price Category 3	+\$15
Price Category 4	+\$22

Ethospace® Walls

2-Way 90° Connector Cover,
Monolithic

E1274.

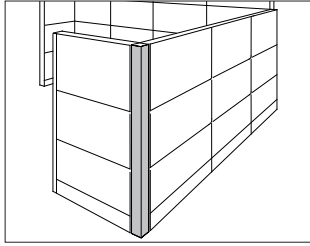

2-Way 90° Connector Cover,
Architectural

E1281.

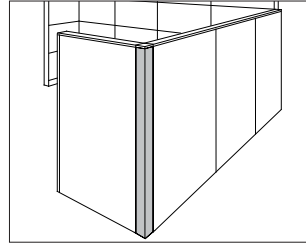

Ethospace® Walls

Specification Information

Step 1.

E1274.

Step 2. Height

30	30" high
38	38" high
46	46" high
54	54" high
62	62" high
70	70" high
86	86" high

Step 3. Surface Material

SS vinyl

Prices for Steps 1-3.

		SS
E1274. 30		\$140
38		\$146
46		\$156
54		\$170
62		\$181
70		\$190
86		\$210

Step 4. Surface Finish

Thermoplastic-Textured Surface

BU	black umber	+\$0
HF	inner tone light	+\$0
LU	soft white	+\$0
MT	medium tone	+\$0

Specification Information

Step 1.

E1281.

Step 2. Height

30	30" high
38	38" high
46	46" high
54	54" high
62	62" high
70	70" high
86	86" high

Step 3. Surface Material

P painted
F fabric

Prices for Steps 1-3.

		P	F
E1281. 30		\$188	229
38		\$202	251
46		\$211	276
54		\$225	296
62		\$242	326
70		\$257	351
86		\$271	388

Step 4. Surface Finish

For painted (P)

BU	black umber	+\$0
HF	inner tone light	+\$0
LU	soft white	+\$0
MT	medium tone	+\$0
CN	metallic champagne	+\$0

For fabric (F)

Price Category 1	+\$0
Price Category 2	+\$7
Price Category 3	+\$15
Price Category 4	+\$22

Spacer Connector Cover

E1271.

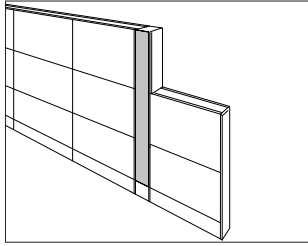

Specification Information

Step 1.

E1271.

Step 2. Height

30	30" high
38	38" high
46	46" high
54	54" high
62	62" high
70	70" high
86	86" high

Step 3. Surface Material

S	vinyl
F	fabric

Prices for Steps 1-3.

	S	F
E1271. 30	\$169	183
38	\$187	191
46	\$199	201
54	\$206	210
62	\$217	221
70	\$226	229
86	\$248	251

Step 4. Surface Finish Side 1

For vinyl (S)

Thermoplastic-Textured Surface

BU	black umber	+ \$0
HF	inner tone light	+ \$0
HT	inner tone	+ \$0
LU	soft white	+ \$0
MT	medium tone	+ \$0

Step 5. Surface Finish Side 2

For vinyl (S)

Thermoplastic-Textured Surface

BU	black umber	+ \$0
HF	inner tone light	+ \$0
HT	inner tone	+ \$0
LU	soft white	+ \$0
MT	medium tone	+ \$0

Step 6. Surface Finish Side 1

For fabric (F)

See application chart and textiles list for fabric usage and numbers. First 2 digits of number indicate fabric line; remaining digit(s) indicate fabric color.

Price Category 1	+ \$0
Price Category 2	+ \$5
Price Category 3	+ \$11
Price Category 4	+ \$15

Step 7. Surface Finish Side 2

For fabric (F)

See application chart and textiles list for fabric usage and numbers. First 2 digits of number indicate fabric line; remaining digit(s) indicate fabric color.

Price Category 1	+ \$0
Price Category 2	+ \$5
Price Category 3	+ \$11
Price Category 4	+ \$15

Spacer Connector Cover,
Monolithic

E1275.

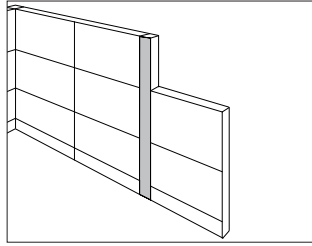

Spacer/3-Way 90° Connector
Cover, Architectural

E1282.

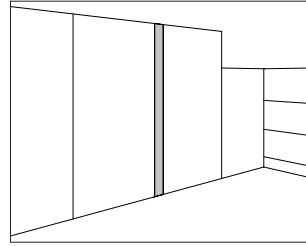

Ethospace® Walls

Specification Information

Step 1.

E1275.

Step 2. Height

30S	30" high
38S	38" high
46S	46" high
54S	54" high
62S	62" high
70S	70" high
86S	86" high

Prices for Steps 1-2.

E1275. 30S	\$199
38S	\$208
46S	\$221
54S	\$230
62S	\$240
70S	\$251
86S	\$273

Step 3. Surface Finish Side 1

BU	black umber	+\$0
HF	inner tone light	+\$0
LU	soft white	+\$0
MT	medium tone	+\$0

Step 4. Surface Finish Side 2

BU	black umber	+\$0
HF	inner tone light	+\$0
LU	soft white	+\$0
MT	medium tone	+\$0

Specification Information

Step 1.

E1282.

Step 2. Height

30	30" high
38	38" high
46	46" high
54	54" high
62	62" high
70	70" high
86	86" high

Step 3. Surface Material

P	Painted
F	fabric

Prices for Steps 1-3.

		P	F
E1282. 30		\$205	256
38		\$219	268
46		\$229	285
54		\$238	296
62		\$253	321
70		\$264	325
86		\$286	355

Step 4. Surface Finish

For painted (P)

BU	black umber	+\$0
HF	inner tone light	+\$0
LU	soft white	+\$0
MT	medium tone	+\$0
CN	metallic champagne	+\$0

For fabric (F)

Price Category 1	+\$0
Price Category 2	+\$5
Price Category 3	+\$11
Price Category 4	+\$15

3-Way 90° Connector Cover

E1272.

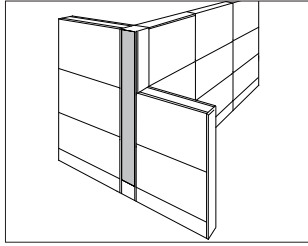

Specification Information

Step 1.

E1272.

Step 2. Height

30	30" high
38	38" high
46	46" high
54	54" high
62	62" high
70	70" high
86	86" high

Step 3. Surface Material

S	vinyl
F	fabric

Prices for Steps 1-3.

	S	F
E1272. 30	\$125	143
38	\$133	147
46	\$140	155
54	\$145	161
62	\$151	170
70	\$157	178
86	\$174	189

Step 4. Surface Finish

Thermoplastic-Textured Surface

For vinyl (S)

BU	black umber	+\$0
HF	inner tone light	+\$0
HT	inner tone	+\$0
LU	soft white	+\$0
MT	medium tone	+\$0

For fabric (F)

Price Category 1	+\$0
Price Category 2	+\$5
Price Category 3	+\$11
Price Category 4	+\$15

3-Way 90° Connector Cover,
Monolithic

E1276.

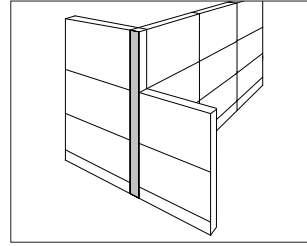

Specification Information

Step 1.

E1276.

Step 2. Height

30S	30" high
38S	38" high
46S	46" high
54S	54" high
62S	62" high
70S	70" high
86S	86" high

Prices for Steps 1-2.

E1276. 30S	\$139
38S	\$144
46S	\$152
54S	\$158
62S	\$170
70S	\$177
86S	\$189

Step 3. Surface Finish

Thermoplastic-Textured Surface

BU	black umber	+\$0
HF	inner tone light	+\$0
LU	soft white	+\$0
MT	medium tone	+\$0

Finished End

E1250.

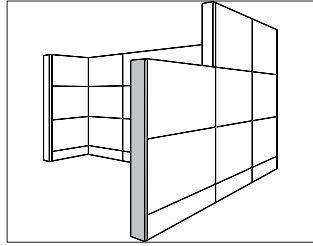

Finished End, Change of Height

E1251.

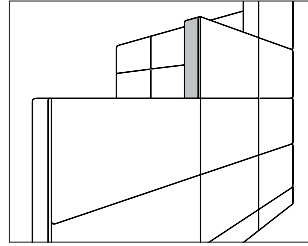

Ethospace® Walls

Specification Information

Step 1.

E1250.

Step 2. Height

30	30" high
38	38" high
46	46" high
54	54" high
62	62" high
70	70" high
86	86" high

Step 3. Shape

S	standard
A	paint architectural

Prices for Steps 1-3.

	S	A
E1250. 30	\$79	106
38	\$82	109
46	\$84	116
54	\$89	123
62	\$93	137
70	\$96	151
86	\$108	169

Step 4. Surface Finish

BU	black umber	+\$0
HF	inner tone light	+\$0
LU	soft white	+\$0
MT	medium tone	+\$0
WN	warm grey neutral	+\$0
CN	metallic champagne	+\$0

Specification Information

Step 1.

E1251.

Step 2. Height

08	8" high
16	16" high
24	24" high
32	32" high

Step 3. Shape

S	standard
A	paint architectural

Prices for Steps 1-3.

	S	A
E1251. 08	\$60	80
16	\$64	94
24	\$73	108
32	\$79	116

Step 4. Surface Finish

BU	black umber	+\$0
CN	metallic champagne	+\$0
HF	inner tone light	+\$0
LU	soft white	+\$0
MT	medium tone	+\$0
WN	warm grey neutral	+\$0

Frame Top Cap

E1260.

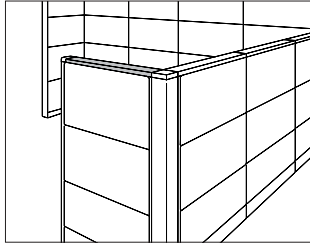

Specification Information

Step 1.

E1260.

Step 2. Width

24	24" wide
30	30" wide
36	36" wide
42	42" wide
48	48" wide

Step 3. Shape

S	standard
A	painting architectural

Prices for Steps 1-3.

	S	A
E1260. 24	\$27	76
30	\$28	86
36	\$29	103
42	\$31	113
48	\$33	125

Step 4. Surface Finish

For standard (S) or painting architectural (A)

BU	black umber	+\$0
CN	metallic champagne	+\$0
HF	inner tone light	+\$0
LU	soft white	+\$0
MT	medium tone	+\$0
WN	warm grey neutral	+\$0

Connector Top Cap

E1261.

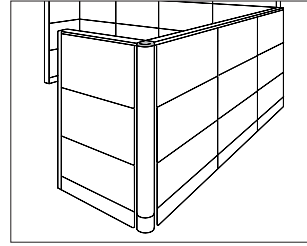

Specification Information

Step 1.

E1261.

Step 2. Configuration

1	spacer
2	2-way 90° radius-shaped connector
5	2-way 90° square-shaped connector
3	3-way 90° connector
4	4-way 90° connector

Step 3. Shape

S	standard
A	painting architectural

Prices for Steps 1-3.

	S	A
E1261. 1	\$39	82
2	\$39	82
5	\$39	82
3	\$39	82
4	\$39	82

Step 4. Surface Finish

For standard (S)

BU	black umber	+\$0
HF	inner tone light	+\$0
LU	soft white	+\$0
MT	medium tone	+\$0

For painting architectural (A)

BU	black umber	+\$0
HF	inner tone light	+\$0
LU	soft white	+\$0
MT	medium tone	+\$0
CN	metallic champagne	+\$0

Power Entry, External Direct
Connect, 4 Circuit

E1322.

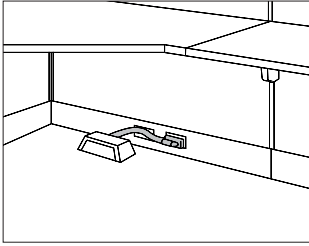

Power Entry, Internal Direct
Connect, 4 Circuit

E1325.

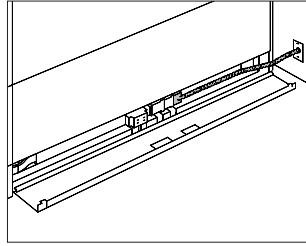

Ethospace® Walls

Specification Information

Step 1.

E1322.

Step 2. Length

06E 6' long

24E 24' long

Prices for Steps 1-2.

E1322. 06E \$192

24E \$397

Specification Information

Step 1.

E1325.6E

\$212

Base Power Entry, Junction Box, 4 Circuit E1323.

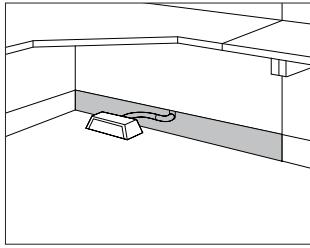

Specification Information

Step 1.

E132

Step 2. Base Option

3. plain base

Step 3. Width

- 24E** 24" wide
- 30E** 30" wide
- 36E** 36" wide
- 42E** 42" wide
- 48E** 48" wide

Prices for Steps 1-3.

E1323. 24E	\$392
30E	\$408
36E	\$422
42E	\$453
48E	\$482

Step 4. Surface Finish

BU black umber	+ \$0
HF inner tone light	+ \$0
HT inner tone	+ \$0
LU soft white	+ \$0
MT medium tone	+ \$0

Ceiling Power Entry, Internal Direct Connect E1331.

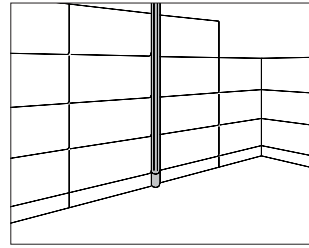

Specification Information

Step 1.

E1331.

Step 2. Height

- 46** 46" high
- 54** 54" high
- 62** 62" high
- 70** 70" high
- 86** 86" high

Step 3. Attachment

C connector- or frame-attached

Step 4. Power

- N** (N) nonpowered
- E** (E) 4-circuit power

Prices for Steps 1-4.

	N	E
E1331. 46 C	\$579	920
54 C	\$612	950
62 C	\$638	978
70 C	\$661	999
86 C	\$711	1050

Step 5. Surface Finish

BU black umber	+ \$0
HF inner tone light	+ \$0
LU soft white	+ \$0
MT medium tone	+ \$0

Step 6. Cable Management Finish

BU black umber	+ \$0
HF inner tone light	+ \$0
HT inner tone	+ \$0
LU soft white	+ \$0
MT medium tone	+ \$0

Baseline Harness, 4 Circuit

E1354.
E1355.

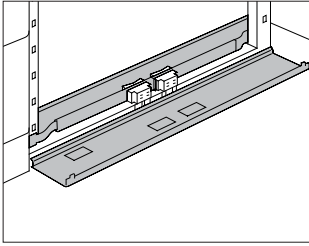

Pass-Through Harness, Frame

E1342.

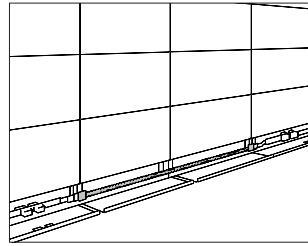

Ethospace® Walls

Specification Information

Step 1.

E135

Step 2. Side Covers

- 4. no side covers
- 5. side covers

Step 3. Frame Width

- 24 24" wide
- 30 30" wide
- 36 36" wide
- 42 42" wide
- 48 48" wide

Step 4. Power Connection

- E standard

Prices for Steps 1-4.

	E
E1354. 24	\$146
30	\$154
36	\$160
42	\$171
48	\$179

E1355. 24	\$253
30	\$253
36	\$253
42	\$260
48	\$260

Step 5. Cable Management Finish

For side covers (5.)

BU black umber	+\$0
HF inner tone light	+\$0
HT inner tone	+\$0
LU soft white	+\$0
MT medium tone	+\$0

Specification Information

Step 1.

E1342.

Step 2. Length

- 24E** 24" long
- 30E** 30" long
- 36E** 36" long
- 42E** 42" long
- 48E** 48" long

Prices for Steps 1-2.

E1342. 24E	\$150
30E	\$157
36E	\$166
42E	\$177
48E	\$184

Pass-Through Harness,
Connector

E1356.

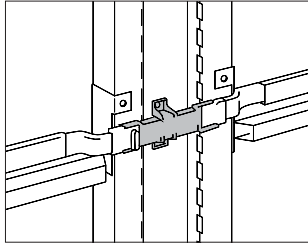

Specification Information

Step 1.

E1356.

Step 2. Configuration

- AE** 2-way 90° connector
- BE** spacer
- CE** 3-way 90° connector
- DE** 4-way 90° connector

Prices for Steps 1-2.

E1356. AE	\$215
BE	\$225
CE	\$230
DE	\$236

Beltline Harness, 4 Circuit

E1353.

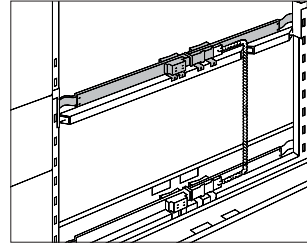

Specification Information

Step 1.

E1353.

Step 2. Frame Width

- 24** 24"-wide frame
- 30** 30"-wide frame
- 36** 36"-wide frame
- 42** 42"-wide frame
- 48** 48"-wide frame

Step 3. Power Connection

- E** standard

Prices for Steps 1-3.

	E
E1353. 24	\$215
30	\$225
36	\$229
42	\$235
48	\$242

Tile-Height Harness, 4 Circuit

E1357.

Power Jumper, 4 Circuit

E1341.

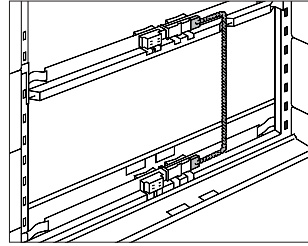
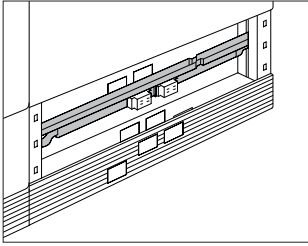

Ethospace® Walls

Specification Information

Step 1.

E1357.

Step 2. Frame Width

- 24E** 24"-wide frame
- 30E** 30"-wide frame
- 36E** 36"-wide frame
- 42E** 42"-wide frame
- 48E** 48"-wide frame

Prices for Steps 1-2.

E1357. 24E	\$215
30E	\$225
36E	\$229
42E	\$235
48E	\$242

Specification Information

Step 1.

E1341.

Step 2. Configuration

- 3E** 4th 8" tile above base
- 5E** 6th 8" tile above base

Prices for Steps 1-2.

E1341. 3E	\$121
5E	\$145

Baseline Box Assembly, H-Style
Frame

EW400.

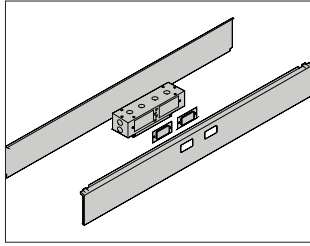

Specification Information

Step 1.

EW400.

Step 2. Width

24	24" wide
30	30" wide
36	36" wide
42	42" wide
48	48" wide

Prices for Steps 1-2.

EW400. 24	\$255
30	\$264
36	\$273
42	\$285
48	\$307

Step 3. Bezel Finish

BU	black umber	+\$0
HF	inner tone light	+\$0
LU	soft white	+\$0
MT	medium tone	+\$0

Receptacle, 4 Circuit, 15 Amp

E1311.

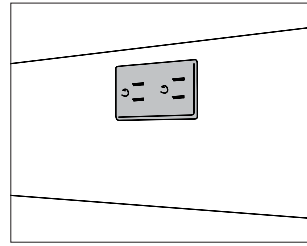

Specification Information

Step 1.

E1311.

Step 2. Type

A	duplex, circuit a
B	duplex, circuit b
C	duplex, circuit c
DN	duplex, circuit d
BI	duplex, circuit b, isolated ground
CI	duplex, circuit c, isolated ground
D	duplex, circuit d, isolated ground
CS	duplex, 3 circuit, circuit c, isolated ground

Prices for Steps 1-2.

E1311. A	\$217
B	\$217
C	\$217
DN	\$217
BI	\$217
CI	\$217
D	\$217
CS	\$217

Step 3. Surface Finish

BU	black umber	+\$0
HF	inner tone light	+\$0
HT	inner tone	+\$0
LU	soft white	+\$0
MT	medium tone	+\$0

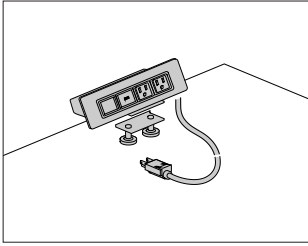

Specification Information

Step 1.
Y1323.

Step 2. Configuration

- 3** 2 simplex receptacles, 2 data openings
- 4** 3 simplex receptacles, 3 data openings
- 5** 2 simplex receptacles, 1 data opening, 1 charging USB port
- 6** 3 simplex receptacles, 2 data opening, 1 charging USB port

Step 3. Power Type

- A** power cord with plug end
- B** conduit with open end, for hard-wiring

Step 4. Cord/Conduit Length

- 03** 3' cord/conduit
- 06** 6' cord/conduit
- 10** 10' cord/conduit
- 20** 20' cord/conduit

Step 5. Attachment

- G** grommet mount
- S** surface clamp

Prices for Steps 1-5.

		03G	03S	06G	06S	10G	10S
Y1323. 3	A	\$279	279	279	279	288	288
	B	\$332	332	332	332	341	341
4	A	\$347	347	347	347	356	356
	B	\$402	402	402	402	412	412
5	A	\$390	390	390	390	400	400
	B	\$444	444	444	444	453	453
6	A	\$459	459	459	459	469	469
	B	\$513	513	513	513	523	523

		20G	20S
Y1323. 3	A	\$337	337
	B	\$388	388
4	A	\$407	407
	B	\$459	459
5	A	\$449	449
	B	\$521	521
6	A	\$517	517
	B	\$592	592

Step 6. Finish

- 0H** black +\$0
- 0I** silver +\$0
- 0J** white +\$0

Cable Manager, Extra Capacity

E1396.

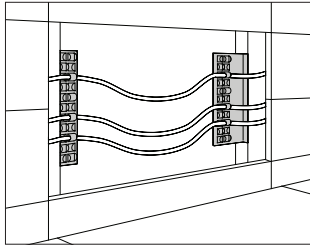

Specification Information

Step 1.

E1396.

\$84

Communication Port Faceplate Reducer

G1189.

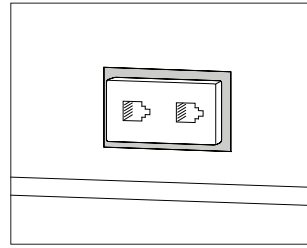

Specification Information

Step 1.

G1189.A

\$51

Communication Port Faceplate
Extender

G1189.

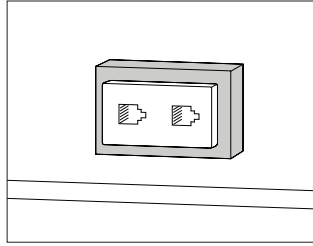

Beltline Bezel, H-Style Frame

G1510.

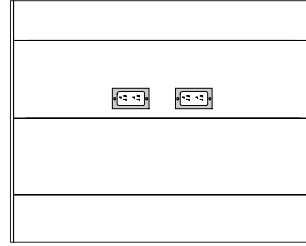

Ethospace® Walls

Specification Information

Step 1.

G1189.B \$64

Step 2. Surface Finish

8Q	folkstone grey	+\$0
BU	black umber	+\$0
CL	cool grey neutral	+\$0
HF	inner tone light	+\$0
MT	medium tone	+\$0
WL	sandstone	+\$0
WN	warm grey neutral	+\$0

Specification Information

Step 1.

G1510. \$52

Step 2. Surface Finish

BU	black umber	+\$0
HF	inner tone light	+\$0
LU	soft white	+\$0
MT	medium tone	+\$0

Face Tile

E1420.

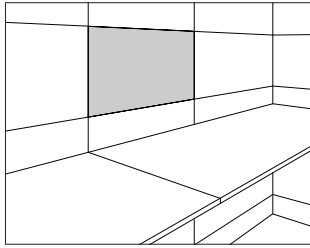

Specification Information

Step 1.

E1420.

Step 2. Height

- 08** 8" high
- 16** 16" high
- 24** 24" high

Step 3. Width

- 24** 24" wide
- 30** 30" wide
- 36** 36" wide
- 42** 42" wide
- 48** 48" wide

Step 4. Surface Material

- P** painted
- F** fabric

Prices for Steps 1-4.

	P	F
E1420. 08 24	\$53	71
30	\$56	75
36	\$62	85
42	\$70	98
48	\$73	105
16 24	\$58	95
30	\$63	100
36	\$68	111
42	\$77	118
48	\$81	128
24 24	\$94	115
30	\$100	124
36	\$107	139
42	\$116	146
48	\$128	160

Step 5. Surface Finish

For painted (P)

BU	black umber	+\$0
HF	inner tone light	+\$0
LU	soft white	+\$0
MT	medium tone	+\$0
CN	metallic champagne	+\$0

For fabric (F)

	08	16	24
Price Category 1	+\$0	0	0
Price Category 2	+\$4	13	19
Price Category 3	+\$8	22	33
Price Category 4	+\$13	33	51

Floor-Length Face Tile

E1420.

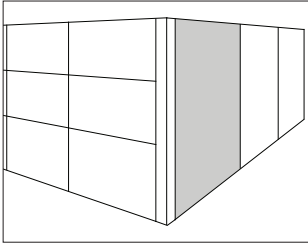

Ethospace® Walls

Specification Information

Step 1.

E1420.

Step 2. Height

22 22" high

30 30" high

Step 3. Width

24 24" wide

30 30" wide

36 36" wide

42 42" wide

48 48" wide

Step 4. Surface Material

P painted

F fabric

Prices for Steps 1-4.

	P	F
E1420. 22 24	\$106	116
30	\$114	124
36	\$122	136
42	\$127	143
48	\$143	158
30 24	\$112	122
30	\$124	140
36	\$139	151
42	\$150	164
48	\$161	181

Step 5. Surface Finish

See application chart and textiles list for fabric usage and numbers. First 2 digits of number indicate fabric line; remaining digit(s) indicate fabric color.

For 22" high (22) with painted (P)

BU	black umber	+\$0
HF	inner tone light	+\$0
LU	soft white	+\$0
MT	medium tone	+\$0
CN	metallic champagne	+\$0

For 30" high (30) with painted (P)

BU	black umber	+\$0
HF	inner tone light	+\$0
LU	soft white	+\$0
MT	medium tone	+\$0

For fabric (F)

	22	30
Price Category 1	+\$0	0
Price Category 2	+\$13	19
Price Category 3	+\$22	33
Price Category 4	+\$33	51

Architectural Cladding, Fabric

E1445.

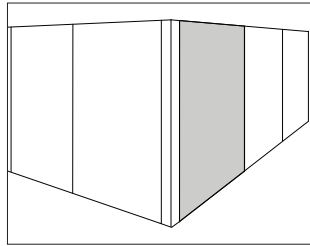

Specification Information

Step 1.

E1445.

Step 2. Height

16	16" high
24	24" high
30	30" high
32	32" high

Step 3. Width

24F	24" wide
30F	30" wide
36F	36" wide
42F	42" wide
48F	48" wide

Prices for Steps 1-3.

	24F	30F	36F	42F	48F
E1445. 16	\$164	174	182	190	198
24	\$198	209	223	231	246
30	\$225	242	252	265	279
32	\$244	259	272	284	302

Step 4. Surface Finish

See application chart and textiles list for fabric usage and numbers.
First 2 digits of number indicate fabric line; remaining digit(s) indicate fabric color.

	16	24	30	32
Price Category 1	+\$0	0	0	0
Price Category 2	+\$13	19	19	25
Price Category 3	+\$22	33	33	44
Price Category 4	+\$33	51	51	66

Acoustical Tile

E1423.

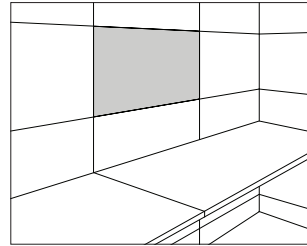

Specification Information

Step 1.

E142

Step 2. Acoustical Rating

3.16 .65 NRC, 20 STC

Step 3. Width

24	24" wide
30	30" wide
36	36" wide
42	42" wide
48	48" wide

Prices for Steps 1-3.

E1423.16 24	\$103
30	\$115
36	\$129
42	\$148
48	\$158

Step 4. Surface Finish

See application chart and textiles list for fabric usage and numbers.
First 2 digits of number indicate fabric line; remaining digit(s) indicate fabric color.

Price Category 1	+\$0
Price Category 2	+\$13
Price Category 3	+\$22
Price Category 4	+\$33

Tackable Tile

E1422.

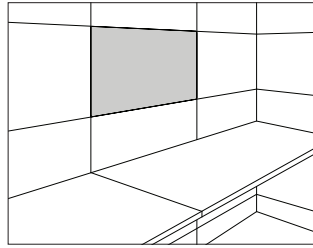

Specification Information

Step 1.

E1422.16

Step 2. Width

24	24" wide
30	30" wide
36	36" wide
42	42" wide
48	48" wide

Prices for Steps 1-2.

E1422.16	24	\$116
	30	\$128
	36	\$144
	42	\$164
	48	\$180

Step 3. Surface Finish

See application chart and textiles list for fabric usage and numbers. First 2 digits of number indicate fabric line; remaining digit(s) indicate fabric color.

Price Category 1	+\$0
Price Category 2	+\$13
Price Category 3	+\$22
Price Category 4	+\$33

Cable Access Tile

E1436.

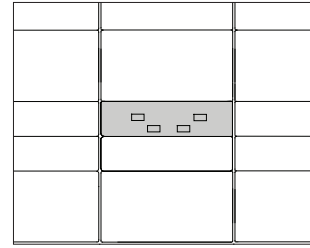

Specification Information

Step 1.

E1436.08

Step 2. Width

24	24" wide
30	30" wide
36	36" wide
42	42" wide
48	48" wide

Step 3. Surface Material

P	Painted
F	Fabric

Prices for Steps 1-3.

		P	F
E1436.08	24	\$107	124
	30	\$127	146
	36	\$134	155
	42	\$142	167
	48	\$147	176

Step 4. Receptacle Filler Finish

BU	black umber	+\$0
HF	inner tone light	+\$0
HT	inner tone	+\$0
LU	soft white	+\$0
MT	medium tone	+\$0

Step 5. Surface Finish

See application chart and textiles list for fabric usage and numbers. First 2 digits of number indicate fabric line; remaining digit(s) indicate fabric color.

For painted (P)

BU	black umber	+\$0
HF	inner tone light	+\$0
LU	soft white	+\$0
MT	medium tone	+\$0
CN	metallic champagne	+\$0

For fabric (F)

Price Category 1	+\$0
Price Category 2	+\$4
Price Category 3	+\$9
Price Category 4	+\$15

Cable Channel Tile

E1433.

Open Tile

E1440.

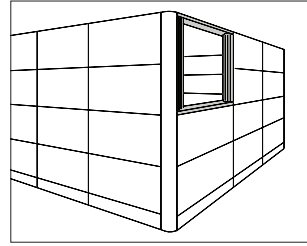
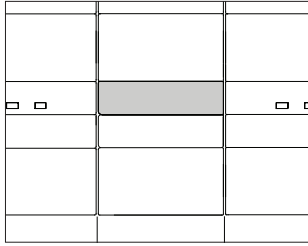

Specification Information

Step 1.

E1433.08

Step 2. Width

- 24** 24" wide
- 30** 30" wide
- 36** 36" wide
- 42** 42" wide
- 48** 48" wide

Step 3. Surface Material

- P** painted
- F** fabric

Prices for Steps 1-3.

		P	F
E1433.08	24	\$100	115
	30	\$117	142
	36	\$125	147
	42	\$137	160
	48	\$143	173

Step 4. Surface Finish

See application chart and textiles list for fabric usage and numbers. First 2 digits of number indicate fabric line; remaining digit(s) indicate fabric color.

For painted (P)

BU	black umber	+\$0
HF	inner tone light	+\$0
LU	soft white	+\$0
MT	medium tone	+\$0
CN	metallic champagne	+\$0

For fabric (F)

Price Category 1	+\$0
Price Category 2	+\$4
Price Category 3	+\$9
Price Category 4	+\$15

Specification Information

Step 1.

E1440.

Step 2. Height

- 16** 16" high

Step 3. Width

- 24** 24" wide
- 30** 30" wide
- 36** 36" wide
- 42** 42" wide
- 48** 48" wide

Step 4. Tile Position

- T** top
- M** middle/bottom

Prices for Steps 1-4.

		T	M
E1440. 16	24	\$221	177
	30	\$259	210
	36	\$288	230
	42	\$310	250
	48	\$337	271

Step 5. Frame Finish

BU	black umber	+\$0
HF	inner tone light	+\$0
LU	soft white	+\$0
MT	medium tone	+\$0

Open Tile, Squared Stile

E1444.

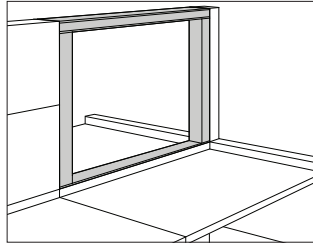

Perforated Tile, Squares

E1441.

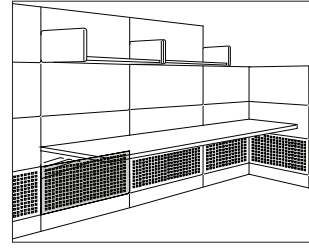

Ethospace® Walls

Specification Information

Step 1.

E1444.

Step 2. Height

16	16" high
32	32" high
48	48" high

Step 3. Width

24	24" wide
30	30" wide
36	36" wide
42	42" wide
48	48" wide

Step 4. Tile Position

T	top
M	middle/bottom

Prices for Steps 1-4.

		T	M
E1444. 16	24	\$222	164
	30	\$258	193
	36	\$287	212
	42	\$311	231
	48	\$337	250
32	24	\$296	223
	30	\$338	252
	36	\$373	279
	42	\$405	303
	48	\$441	333
48	24	\$376	282
	30	\$409	307
	36	\$449	337
	42	\$488	363
	48	\$525	392

Step 5. Frame Finish

BU	black umber	+\$0
HF	inner tone light	+\$0
LU	soft white	+\$0
MT	medium tone	+\$0

Specification Information

Step 1.

E1441.

Step 2. Height

16	16" high
-----------	----------

Step 3. Width

24P	24" wide
30P	30" wide
36P	36" wide
42P	42" wide
48P	48" wide

Prices for Steps 1-3.

	24P	30P	36P	42P	48P
E1441. 16	\$74	80	93	99	107

Step 4. Surface Finish

BU	black umber	+\$0
HF	inner tone light	+\$0
LU	soft white	+\$0
MT	medium tone	+\$0
CN	metallic champagne	+\$0

Rail Tile

E1425.

Tool Bar

E3610.

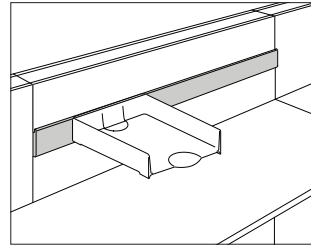
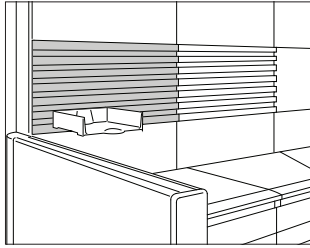

Specification Information

Step 1.

E1425.

Step 2. Height

16 16" high

Step 3. Width

24 24" wide

30 30" wide

36 36" wide

42 42" wide

48 48" wide

Prices for Steps 1-3.

	24	30	36	42	48
E1425. 16	\$190	211	230	254	272

Step 4. Surface Finish

BU	black umber	+\$0
HF	inner tone light	+\$0
LU	soft white	+\$0
MT	medium tone	+\$0
CN	metallic champagne	+\$0

Specification Information

Step 1.

E3610.

Step 2. Width

24 24" wide

30 30" wide

36 36" wide

42 42" wide

48 48" wide

Prices for Steps 1-2.

E3610. 24	\$71
30	\$82
36	\$94
42	\$103
48	\$112

Step 3. Surface Finish

BU	black umber	+\$0
HF	inner tone light	+\$0
LU	soft white	+\$0
MT	medium tone	+\$0
CN	metallic champagne	+\$0

Rectangular Surface

EWS10.

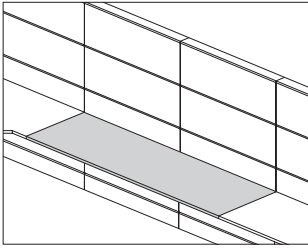

Ethospace® Work Surfaces

Specification Information

Step 1.

EW

Step 2. Edge

S10. squared-edge

Step 3. Depth

24 24" deep

30 30" deep

Step 4. Width

24 24" wide

30 30" wide

36 36" wide

42 42" wide

48 48" wide

60 60" wide

66 66" wide

72 72" wide

Step 5. Surface Material

L laminate top/thermoplastic edge

Step 6. Attachment

For 24" deep (24) or 30" deep (30) with 24" wide (24), 30" wide (30), 66" wide (66), or 72" wide (72)

F Ethospace® frame attached surface

For 24" deep (24) or 30" deep (30) with 36" wide (36), 42" wide (42), 48" wide (48), or 60" wide (60)

D surface attachment bracket

F Ethospace® frame attached surface

Prices for Steps 1-6.

	LD	LF
EWS10.24 24	—	\$166
30	—	\$189
36	\$259	216
42	\$282	240
48	\$310	266
60	\$398	354
66	—	\$398
72	—	\$442

30 24	—	\$181
30	—	\$232
36	\$314	270
42	\$350	309
48	\$390	346
60	\$501	458
66	—	\$521
72	—	\$580

Step 7. Top Finish

76	light brown walnut	+\$0
8Q	folkstone grey	+\$0
91	white	+\$0
98	studio white	+\$0
CL	cool grey neutral	+\$0
HF	inner tone light	+\$0
HM	natural maple	+\$0
HP	light anigre	+\$0
HT	inner tone	+\$0
HX	aged cherry	+\$0
HY	walnut on cherry	+\$0
LA	light ash	+\$0
LBA	clear on ash	+\$0
LBB	oak on ash	+\$0
LBC	walnut on ash	+\$0
LBD	dark brown walnut	+\$0
LBE	medium red walnut	+\$0
LBF	neutral twill	+\$0
LBG	sarum twill	+\$0
LBH	earthen twill	+\$0
LBJ	graphite twill	+\$0
LBK	pewter mesh	+\$0
LBL	steel mesh	+\$0
LBM	crisp linen	+\$0
LBN	classic linen	+\$0
LBP	casual linen	+\$0
LBQ	white twill	+\$0
LM	mahogany	+\$0
LT	light tone	+\$0
LU	soft white	+\$0
MT	medium tone	+\$0
WL	sandstone	+\$0
WN	warm grey neutral	+\$0

Step 8. Edge Finish

76	light brown walnut	+\$0
8Q	folkstone grey	+\$0

8Z	neutral grey	+\$0
91	white	+\$0
98	studio white	+\$0
BU	black umber	+\$0
CL	cool grey neutral	+\$0
HF	inner tone light	+\$0
HM	natural maple	+\$0
HP	light anigre	+\$0
HT	inner tone	+\$0
HX	aged cherry	+\$0
HY	walnut on cherry	+\$0
JB	millwork cherry	+\$0
LA	light ash	+\$0
LBA	clear on ash	+\$0
LBB	oak on ash	+\$0
LBC	walnut on ash	+\$0
LBD	dark brown walnut	+\$0
LBE	medium red walnut	+\$0
LBF	neutral twill	+\$0
LBG	sarum twill	+\$0
LBH	earthen twill	+\$0
LBJ	graphite twill	+\$0
LBK	pewter mesh	+\$0
LBL	steel mesh	+\$0
LBM	crisp linen	+\$0
LBN	classic linen	+\$0
LBP	casual linen	+\$0
LBQ	white twill	+\$0
LU	soft white	+\$0
MT	medium tone	+\$0
WL	sandstone	+\$0
WN	warm grey neutral	+\$0

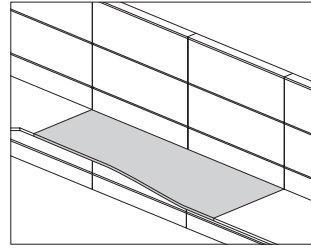

Specification Information	
Step 1.	
EW	
Step 2. Edge	
S12.	squared-edge
Step 3. Depth	
24	24" deep left, 30" deep right
30	30" deep left, 24" deep right
Step 4. Width	
30	30" wide
36	36" wide
42	42" wide
48	48" wide
60	60" wide
Step 5. Surface Material	
L	laminate top/thermoplastic edge
Step 6. Attachment	
F	Ethospace® frame attached surface
Prices for Steps 1-6.	
	LF
EWS12.24 30	\$286
36	\$306
42	\$357
48	\$411
60	\$429
30 30	\$286
36	\$306
42	\$357
48	\$411
60	\$429

Curvilinear Surface *continued*

Ethospace® Work Surfaces

Step 7. Top Finish		
76	light brown walnut	+\$0
8Q	folkstone grey	+\$0
91	white	+\$0
98	studio white	+\$0
CL	cool grey neutral	+\$0
HF	inner tone light	+\$0
HM	natural maple	+\$0
HP	light anigre	+\$0
HT	inner tone	+\$0
HX	aged cherry	+\$0
HY	walnut on cherry	+\$0
LA	light ash	+\$0
LBA	clear on ash	+\$0
LBB	oak on ash	+\$0
LBC	walnut on ash	+\$0
LBD	dark brown walnut	+\$0
LBE	medium red walnut	+\$0
LBF	neutral twill	+\$0
LBG	sarum twill	+\$0
LBH	earthen twill	+\$0
LBJ	graphite twill	+\$0
LBK	pewter mesh	+\$0
LBL	steel mesh	+\$0
LBM	crisp linen	+\$0
LBN	classic linen	+\$0
LBP	casual linen	+\$0
LBQ	white twill	+\$0
LM	mahogany	+\$0
LT	light tone	+\$0
LU	soft white	+\$0
MT	medium tone	+\$0
WL	sandstone	+\$0
WN	warm grey neutral	+\$0

HX	aged cherry	+\$0
HY	walnut on cherry	+\$0
JB	millwork cherry	+\$0
LA	light ash	+\$0
LBA	clear on ash	+\$0
LBB	oak on ash	+\$0
LBC	walnut on ash	+\$0
LBD	dark brown walnut	+\$0
LBE	medium red walnut	+\$0
LBF	neutral twill	+\$0
LBG	sarum twill	+\$0
LBH	earthen twill	+\$0
LBJ	graphite twill	+\$0
LBK	pewter mesh	+\$0
LBL	steel mesh	+\$0
LBM	crisp linen	+\$0
LBN	classic linen	+\$0
LBP	casual linen	+\$0
LBQ	white twill	+\$0
LU	soft white	+\$0
MT	medium tone	+\$0
WL	sandstone	+\$0
WN	warm grey neutral	+\$0

Step 8. Edge Finish		
76	light brown walnut	+\$0
8Q	folkstone grey	+\$0
8Z	neutral grey	+\$0
91	white	+\$0
98	studio white	+\$0
BU	black umber	+\$0
CL	cool grey neutral	+\$0
HF	inner tone light	+\$0
HM	natural maple	+\$0
HP	light anigre	+\$0
HT	inner tone	+\$0

Corner Surface

EWS20.

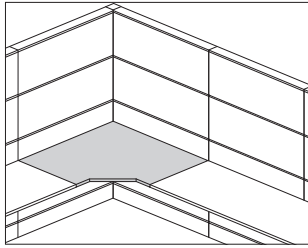

Specification Information

Step 1.

EW

Step 2. Edge

S20. squared-edge

Step 3. Depth

24 24" deep

30 30" deep

Step 4. Width

For 24" deep (24)

36 36" wide

42 42" wide

48 48" wide

For 30" deep (30)

42 42" wide

48 48" wide

Step 5. Surface Material

L laminate top/thermoplastic edge

Step 6. Attachment

F Ethospace® frame attached surface

Prices for Steps 1-6.

	LF
EWS20.24 36	\$319
42	\$391
48	\$463
30 42	\$489
48	\$551

Step 7. Top Finish

76	light brown walnut	+\$0
8Q	folkstone grey	+\$0
91	white	+\$0
98	studio white	+\$0
CL	cool grey neutral	+\$0
HF	inner tone light	+\$0
HM	natural maple	+\$0
HP	light anigre	+\$0
HT	inner tone	+\$0
HX	aged cherry	+\$0
HY	walnut on cherry	+\$0
LA	light ash	+\$0
LBA	clear on ash	+\$0
LBB	oak on ash	+\$0
LBC	walnut on ash	+\$0
LBD	dark brown walnut	+\$0
LBE	medium red walnut	+\$0
LBF	neutral twill	+\$0
LBG	sarum twill	+\$0
LBH	earthen twill	+\$0
LBJ	graphite twill	+\$0
LBK	pewter mesh	+\$0
LBL	steel mesh	+\$0
LBM	crisp linen	+\$0
LBN	classic linen	+\$0
LBP	casual linen	+\$0
LBQ	white twill	+\$0
LM	mahogany	+\$0
LT	light tone	+\$0
LU	soft white	+\$0
MT	medium tone	+\$0
WL	sandstone	+\$0
WN	warm grey neutral	+\$0

Step 8. Edge Finish

76	light brown walnut	+\$0
8Q	folkstone grey	+\$0
8Z	neutral grey	+\$0
91	white	+\$0
98	studio white	+\$0
BU	black umber	+\$0
CL	cool grey neutral	+\$0
HF	inner tone light	+\$0
HM	natural maple	+\$0
HP	light anigre	+\$0
HT	inner tone	+\$0

Ethospace® Work Surfaces

HX	aged cherry	+\$0
HY	walnut on cherry	+\$0
JB	millwork cherry	+\$0
LA	light ash	+\$0
LBA	clear on ash	+\$0
LBB	oak on ash	+\$0
LBC	walnut on ash	+\$0
LBD	dark brown walnut	+\$0
LBE	medium red walnut	+\$0
LBF	neutral twill	+\$0
LBG	sarum twill	+\$0
LBH	earthen twill	+\$0
LBJ	graphite twill	+\$0
LBK	pewter mesh	+\$0
LBL	steel mesh	+\$0
LBM	crisp linen	+\$0
LBN	classic linen	+\$0
LBP	casual linen	+\$0
LBQ	white twill	+\$0
LU	soft white	+\$0
MT	medium tone	+\$0
WL	sandstone	+\$0
WN	warm grey neutral	+\$0

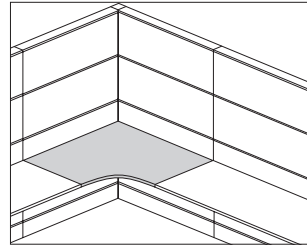

Specification Information

Step 1.

EW

Step 2. Edge

S21. squared-edge

Step 3. Depth

24 24" deep

30 30" deep

Step 4. Width

For 24" deep (24)

36 36" wide

42 42" wide

48 48" wide

For 30" deep (30)

42 42" wide

48 48" wide

Step 5. Surface Material

L laminate top/thermoplastic edge

Step 6. Attachment

F Ethospace® frame attached surface

Prices for Steps 1-6.

	LF
EWS21.24 36	\$319
42	\$391
48	\$463
30 42	\$489
48	\$551

Concave Corner Surface *continued*

Step 7. Top Finish

LU	soft white	+\$0
76	light brown walnut	+\$0
8Q	folkstone grey	+\$0
91	white	+\$0
98	studio white	+\$0
CL	cool grey neutral	+\$0
HF	inner tone light	+\$0
HM	natural maple	+\$0
HP	light anigre	+\$0
HT	inner tone	+\$0
HX	aged cherry	+\$0
HY	walnut on cherry	+\$0
LA	light ash	+\$0
LBA	clear on ash	+\$0
LBB	oak on ash	+\$0
LBC	walnut on ash	+\$0
LBD	dark brown walnut	+\$0
LBE	medium red walnut	+\$0
LBF	neutral twill	+\$0
LBG	sarum twill	+\$0
LBH	earthen twill	+\$0
LBJ	graphite twill	+\$0
LBK	pewter mesh	+\$0
LBL	steel mesh	+\$0
LBM	crisp linen	+\$0
LBN	classic linen	+\$0
LBP	casual linen	+\$0
LBQ	white twill	+\$0
LM	mahogany	+\$0
LT	light tone	+\$0
MT	medium tone	+\$0
WL	sandstone	+\$0
WN	warm grey neutral	+\$0

Step 8. Edge Finish

76	light brown walnut	+\$0
8Q	folkstone grey	+\$0
8Z	neutral grey	+\$0
91	white	+\$0
98	studio white	+\$0
BU	black umber	+\$0
CL	cool grey neutral	+\$0
HF	inner tone light	+\$0
HM	natural maple	+\$0
HP	light anigre	+\$0
HT	inner tone	+\$0

HX	aged cherry	+\$0
HY	walnut on cherry	+\$0
JB	millwork cherry	+\$0
LA	light ash	+\$0
LBA	clear on ash	+\$0
LBB	oak on ash	+\$0
LBC	walnut on ash	+\$0
LBD	dark brown walnut	+\$0
LBE	medium red walnut	+\$0
LBF	neutral twill	+\$0
LBG	sarum twill	+\$0
LBH	earthen twill	+\$0
LBJ	graphite twill	+\$0
LBK	pewter mesh	+\$0
LBL	steel mesh	+\$0
LBM	crisp linen	+\$0
LBN	classic linen	+\$0
LBP	casual linen	+\$0
LBQ	white twill	+\$0
LU	soft white	+\$0
MT	medium tone	+\$0
WL	sandstone	+\$0
WN	warm grey neutral	+\$0

Extended Corner Surface, Rectangular End

EWS22.

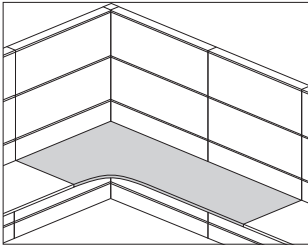

Ethospace® Work Surfaces

Specification Information

Step 1.

EW

Step 2. Edge

S22. squared-edge, 24" deep

Step 3. Width

4260 42" wide left x 60" wide right

4872 48" wide left x 72" wide right

6042 60" wide left x 42" wide right

7248 72" wide left x 48" wide right

Step 4. Surface Material

L laminate top/thermoplastic edge

Step 5. Attachment

F Ethospace® frame attached surface

Prices for Steps 1-5.

	F
EWS22.4260 L	\$742
4872 L	\$879
6042 L	\$742
7248 L	\$879

Step 6. Top Finish

76	light brown walnut	+ \$0
8Q	folkstone grey	+ \$0
91	white	+ \$0
98	studio white	+ \$0
CL	cool grey neutral	+ \$0
HF	inner tone light	+ \$0
HM	natural maple	+ \$0
HP	light anigre	+ \$0
HT	inner tone	+ \$0
HX	aged cherry	+ \$0
HY	walnut on cherry	+ \$0
LA	light ash	+ \$0
LBA	clear on ash	+ \$0
LBB	oak on ash	+ \$0
LBC	walnut on ash	+ \$0
LBD	dark brown walnut	+ \$0
LBE	medium red walnut	+ \$0
LBF	neutral twill	+ \$0
LBG	sarum twill	+ \$0
LBH	earthen twill	+ \$0
LBJ	graphite twill	+ \$0
LBK	pewter mesh	+ \$0
LBL	steel mesh	+ \$0
LBM	crisp linen	+ \$0
LBN	classic linen	+ \$0
LBP	casual linen	+ \$0
LBQ	white twill	+ \$0
LM	mahogany	+ \$0
LT	light tone	+ \$0
LU	soft white	+ \$0
MT	medium tone	+ \$0
WL	sandstone	+ \$0
WN	warm grey neutral	+ \$0

Step 7. Edge Finish

76	light brown walnut	+ \$0
8Q	folkstone grey	+ \$0
8Z	neutral grey	+ \$0
91	white	+ \$0
98	studio white	+ \$0
BU	black umber	+ \$0
CL	cool grey neutral	+ \$0
HF	inner tone light	+ \$0
HM	natural maple	+ \$0
HP	light anigre	+ \$0
HT	inner tone	+ \$0

Extended Corner Surface,
Rectangular End *continued*

HX	aged cherry	+\$0
HY	walnut on cherry	+\$0
JB	millwork cherry	+\$0
LA	light ash	+\$0
LBA	clear on ash	+\$0
LBB	oak on ash	+\$0
LBC	walnut on ash	+\$0
LBD	dark brown walnut	+\$0
LBE	medium red walnut	+\$0
LBF	neutral twill	+\$0
LBG	sarum twill	+\$0
LBH	earthen twill	+\$0
LBJ	graphite twill	+\$0
LBK	pewter mesh	+\$0
LBL	steel mesh	+\$0
LBM	crisp linen	+\$0
LBN	classic linen	+\$0
LBP	casual linen	+\$0
LBQ	white twill	+\$0
LU	soft white	+\$0
MT	medium tone	+\$0
WL	sandstone	+\$0
WN	warm grey neutral	+\$0

Squared-Edge Corner Wedge

Y2091.

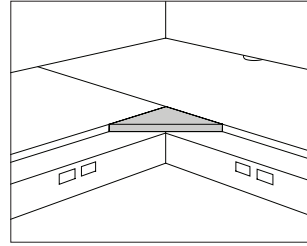

Specification Information

Step 1.

Y2091.

Step 2. Surface Material

L	laminate top/thermoplastic edge
U	laminate top/universal edge

Prices for Steps 1-2.

Y2091. L	\$113
U	\$110

Step 3. Top Finish

76	light brown walnut	+\$0
8Q	folkstone grey	+\$0
91	white	+\$0
98	studio white	+\$0
CL	cool grey neutral	+\$0
HF	inner tone light	+\$0
HM	natural maple	+\$0
HP	light anigre	+\$0
HT	inner tone	+\$0
HX	aged cherry	+\$0
HY	walnut on cherry	+\$0
LA	light ash	+\$0
LBA	clear on ash	+\$0
LBB	oak on ash	+\$0
LBC	walnut on ash	+\$0
LBD	dark brown walnut	+\$0
LBE	medium red walnut	+\$0
LBF	neutral twill	+\$0
LBG	sarum twill	+\$0
LBH	earthen twill	+\$0
LBJ	graphite twill	+\$0
LBK	pewter mesh	+\$0
LBL	steel mesh	+\$0
LBM	crisp linen	+\$0
LBN	classic linen	+\$0
LBP	casual linen	+\$0
LBQ	white twill	+\$0
LM	mahogany	+\$0
LT	light tone	+\$0
LU	soft white	+\$0
MT	medium tone	+\$0
WL	sandstone	+\$0
WN	warm grey neutral	+\$0

Ethospace® Work Surfaces

Squared-Edge Corner Wedge

continued

Ethospace® Work Surfaces

Step 4. Edge Finish

For laminate top/thermoplastic edge (L)

76	light brown walnut	+\$0
8Q	folkstone grey	+\$0
8Z	neutral grey	+\$0
91	white	+\$0
98	studio white	+\$0
BU	black umber	+\$0
CL	cool grey neutral	+\$0
HF	inner tone light	+\$0
HM	natural maple	+\$0
HP	light anigre	+\$0
HT	inner tone	+\$0
HX	aged cherry	+\$0
HY	walnut on cherry	+\$0
JB	millwork cherry	+\$0
LA	light ash	+\$0
LBA	clear on ash	+\$0
LBB	oak on ash	+\$0
LBC	walnut on ash	+\$0
LBD	dark brown walnut	+\$0
LBE	medium red walnut	+\$0
LBF	neutral twill	+\$0
LBG	sarum twill	+\$0
LBH	earthen twill	+\$0
LBJ	graphite twill	+\$0
LBK	pewter mesh	+\$0
LBL	steel mesh	+\$0
LBM	crisp linen	+\$0
LBN	classic linen	+\$0
LBP	casual linen	+\$0
LBQ	white twill	+\$0
LU	soft white	+\$0
MT	medium tone	+\$0
WL	sandstone	+\$0
WN	warm grey neutral	+\$0

Work Surface Support, Single

E2393.

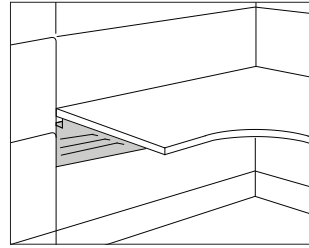

Specification Information

Step 1.

E2393.

Step 2. Work Surface Depth

24 for 20"- or 24"-deep surfaces

30 for 30"-deep surfaces

Step 3. Position

L left

R right

Prices for Steps 1-3.

	L	R
E2393. 24	\$37	37
30	\$41	41

Step 4. Surface Finish

BU	black umber	+\$0
HF	inner tone light	+\$0
LU	soft white	+\$0
MT	medium tone	+\$0
CN	metallic champagne	+\$0

Step 5. Support Option

SM	on module	+\$0
-----------	-----------	------

Surface Ganging Bracket

FT29B.

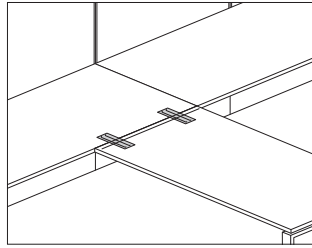

Specification Information

Step 1.

FT29B.

Step 2. Type

- 1** single
- 2** pair

Prices for Steps 1-2.

FT29B. 1	\$22
2	\$42

Work Surface Support Bracket

E2931.

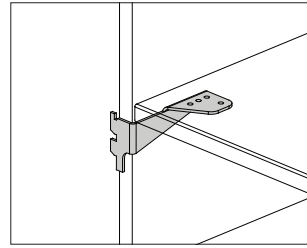

Specification Information

Step 1.

E2931.

Step 2. Position

- L** left
- R** right

Prices for Steps 1-2.

E2931. L	\$61
R	\$61

Step 3. Finish

BU black umber	+\$0
HF inner tone light	+\$0
LU soft white	+\$0
MT medium tone	+\$0

Work Surface Support Panel, End, Glides E2290.

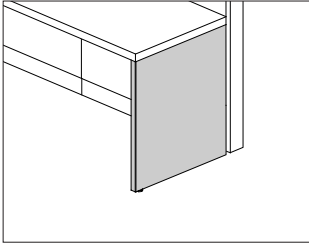

Specification Information	
Step 1.	
E2290.	
Step 2. Depth	
24	24" deep
30	30" deep
Step 3. Work Surface Edge	
S	squared-edge
Step 4. Surface Material	
L	laminate
Prices for Steps 1-4.	
	L
E2290. 24 S	\$327
30 S	\$345
Step 5. Surface Finish	
Solid-Color Laminate	
BU	black umber +\$0
HF	inner tone light +\$0
LU	soft white +\$0
MT	medium tone +\$0
Step 6. Hardware Cover Finish	
8Q	folkstone grey +\$0
91	white +\$0
BU	black umber +\$0
CL	cool grey neutral +\$0
HF	inner tone light +\$0
LU	soft white +\$0
MT	medium tone +\$0
SG	slate grey +\$0
WL	sandstone +\$0
WN	warm grey neutral +\$0

Work Surface Support Panel, Mid-Run, Glides E2291.

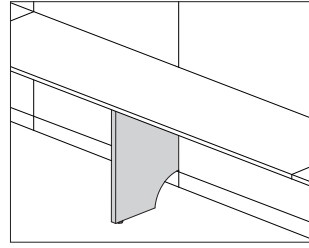

Specification Information	
Step 1.	
E2291.	
Step 2. Size	
20	for 24" and 30" deep surfaces
Step 3. Surface Material	
L	laminate
Prices for Steps 1-3.	
	L
E2291. 20	\$329
Step 4. Surface Finish	
BU	black umber +\$0
HF	inner tone light +\$0
LU	soft white +\$0
MT	medium tone +\$0
Step 5. Bracket Finish	
BU	black umber +\$0
HF	inner tone light +\$0
LU	soft white +\$0
MT	medium tone +\$0

Stiffener

FV696.

Cord Cleat

G1331.

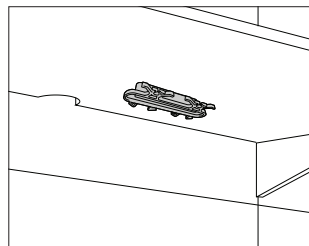
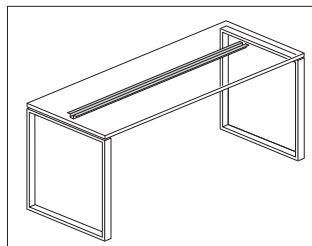

Specification Information

Step 1.

FV696.

Step 2. Width

- 34** 33⁷/₈" wide
- 39** 38⁵/₈" wide
- 43** 43¹/₄" wide
- 48** 48" wide
- 57** 57³/₈" wide
- 62** 62¹/₈" wide
- 67** 66³/₄" wide
- 71** 71¹/₂" wide
- 81** 80⁷/₈" wide

Prices for Steps 1-2.

FV696. 34	\$69
39	\$71
43	\$71
48	\$71
57	\$71
62	\$71
67	\$71
71	\$71
81	\$71

Specification Information

Step 1.

G1331.

\$21

Oval Transaction Surface

E2810.

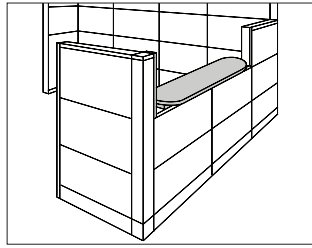

Specification Information

Step 1.
E2810.

Step 2. Width

34	34" wide
40	40" wide
58	58" wide

Step 3. Surface Material

L	laminate
----------	----------

Prices for Steps 1-3.

	L
E2810. 34	\$1405
40	\$1562
58	\$1868

Step 4. Laminate Top Finish/Natural Edge

Solid-Color Laminate Top/Natural Edge

HF	inner tone light	+\$0
HT	inner tone	+\$0
LU	soft white	+\$0

Wood-Grain Laminate Top/Natural Edge

LA	light ash	+\$0
LM	mahogany	+\$0

Step 5. Support Finish

BU	black umber	+\$0
HF	inner tone light	+\$0

Squared-Edge Transaction Surface, Rectangular End

E2812.

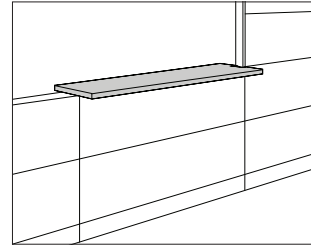

Specification Information

Step 1.
E2812.

Step 2. Width

24L	24" wide
30L	30" wide
36L	36" wide
42L	42" wide
48L	48" wide

Step 3. Finished End Cutout

N	no cutout
C	cutout on one end

Prices for Steps 1-3.

	N	C
E2812. 24L	\$252	301
30L	\$259	313
36L	\$281	333
42L	\$292	347
48L	\$299	355

Squared-Edge Transaction

Surface, Rectangular End *continued*

Step 4. Top Finish

76	light brown walnut	+\$0
8Q	folkstone grey	+\$0
91	white	+\$0
98	studio white	+\$0
CL	cool grey neutral	+\$0
HF	inner tone light	+\$0
HM	natural maple	+\$0
HP	light anigre	+\$0
HT	inner tone	+\$0
HX	aged cherry	+\$0
HY	walnut on cherry	+\$0
LA	light ash	+\$0
LBA	clear on ash	+\$0
LBB	oak on ash	+\$0
LBC	walnut on ash	+\$0
LBD	dark brown walnut	+\$0
LBE	medium red walnut	+\$0
LBF	neutral twill	+\$0
LBG	sarum twill	+\$0
LBH	earthen twill	+\$0
LBJ	graphite twill	+\$0
LBK	pewter mesh	+\$0
LBL	steel mesh	+\$0
LBM	crisp linen	+\$0
LBN	classic linen	+\$0
LBP	casual linen	+\$0
LBQ	white twill	+\$0
LM	mahogany	+\$0
LT	light tone	+\$0
LU	soft white	+\$0
MT	medium tone	+\$0
WL	sandstone	+\$0
WN	warm grey neutral	+\$0

HX	aged cherry	+\$0
HY	walnut on cherry	+\$0
JB	millwork cherry	+\$0
LA	light ash	+\$0
LBA	clear on ash	+\$0
LBB	oak on ash	+\$0
LBC	walnut on ash	+\$0
LBD	dark brown walnut	+\$0
LBE	medium red walnut	+\$0
LBF	neutral twill	+\$0
LBG	sarum twill	+\$0
LBH	earthen twill	+\$0
LBJ	graphite twill	+\$0
LBK	pewter mesh	+\$0
LBL	steel mesh	+\$0
LBM	crisp linen	+\$0
LBN	classic linen	+\$0
LBP	casual linen	+\$0
LBQ	white twill	+\$0
LU	soft white	+\$0
MT	medium tone	+\$0
WL	sandstone	+\$0
WN	warm grey neutral	+\$0

Ethospace® Work Surfaces

Step 5. Edge Finish

76	light brown walnut	+\$0
8Q	folkstone grey	+\$0
8Z	neutral grey	+\$0
91	white	+\$0
98	studio white	+\$0
BU	black umber	+\$0
CL	cool grey neutral	+\$0
HF	inner tone light	+\$0
HM	natural maple	+\$0
HP	light anigre	+\$0
HT	inner tone	+\$0

B-Style Flipper Door Unit

E3212.

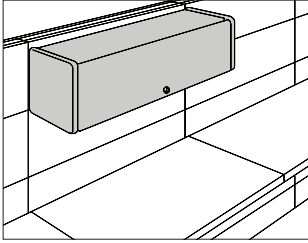

Ethospace® Storage

Specification Information

Step 1.

E321

Step 2. Depth/Door Material

2. 13" deep and painted or fabric door

Step 3. Width

- 24** 24" wide
- 30** 30" wide
- 36** 36" wide
- 42** 42" wide
- 48** 48" wide

Step 4. Door Material

- P** painted door
- F** fabric door

Step 5. Lock

For lock (), skip this step.*

lock

Prices for Steps 1-5.

	*
E3212. 24 P	\$438
F	\$451
30 P	\$463
F	\$476
36 P	\$497
F	\$513
42 P	\$535
F	\$550
48 P	\$566
F	\$580

Step 6. Lock Option

- KA** keyed alike - \$10
- KD** keyed differently + \$0

Step 7. Case Finish

- BU** black umber + \$0
- HF** inner tone light + \$0
- LU** soft white + \$0
- MT** medium tone + \$0
- CN** metallic champagne + \$0

Step 8. Door Finish

For 13" deep and painted or fabric door (2.) with painted door (P)

- BU** black umber + \$0
- HF** inner tone light + \$0
- LU** soft white + \$0
- MT** medium tone + \$0
- CN** metallic champagne + \$0

Step 9. End Panel Option

For 13" deep and painted or fabric door (2.)

- SM** for Ethospace® on module + \$0

Step 10. Door Finish

For 24" wide (24), 30" wide (30), 36" wide (36), 42" wide (42), or 48" wide (48) with fabric door (F)

See application chart and textiles list for fabric usage and numbers. First 2 digits of number indicate fabric line; remaining digit(s) indicate fabric color.

- Price Category 1 + \$0
- Price Category 2 + \$18
- Price Category 3 + \$37
- Price Category 4 + \$54

B-Style Flipper Door

E3217.

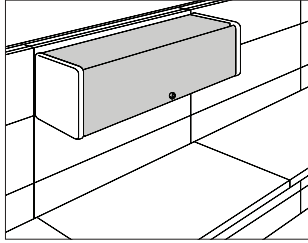

Specification Information

Step 1.

E321

Step 2. Depth/Door Material

7. 13" deep and painted or fabric

Step 3. Width

24 24" wide
30 30" wide
36 36" wide
42 42" wide
48 48" wide

Step 4. Door Material

P painted
F fabric

Step 5. Lock

For lock (), skip this step.*
 lock

Prices for Steps 1-5.

	*
E3217. 24 P	\$278
F	\$290
30 P	\$298
F	\$314
36 P	\$325
F	\$339
42 P	\$351
F	\$367
48 P	\$375
F	\$390

Step 6. Lock Option

KA keyed alike -\$10
KD keyed differently +\$0

Step 7. Top Finish

BU black umber +\$0
HF inner tone light +\$0
LU soft white +\$0
MT medium tone +\$0
CN metallic champagne +\$0

Step 8. Door Finish

See application chart and textiles list for fabric usage and numbers. First 2 digits of number indicate fabric line; remaining digit(s) indicate fabric color.

For 24" wide (24), 30" wide (30), 36" wide (36), 42" wide (42), or 48" wide (48) with fabric (F)

Price Category 1	+\$0
Price Category 2	+\$18
Price Category 3	+\$37
Price Category 4	+\$54

For painted (P)

BU black umber	+\$0
HF inner tone light	+\$0
LU soft white	+\$0
MT medium tone	+\$0
CN metallic champagne	+\$0

Ethospace® Storage

B-Style Shelf

E3230.
E3231.

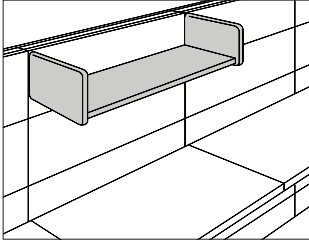

Specification Information

Step 1.

E323

Step 2. Height/Depth

- 0. 7½" high x 13" deep
- 1. 15½" high x 13" deep

Step 3. Width

- 24 24" wide
- 30 30" wide
- 36 36" wide
- 42 42" wide
- 48 48" wide

Prices for Steps 1-3.

E3230.	24	\$134
	30	\$141
	36	\$151
	42	\$162
	48	\$167
<hr/>		
E3231.	24	\$180
	30	\$186
	36	\$196
	42	\$207
	48	\$213

Step 4. Surface Finish

BU	black umber	+\$0
HF	inner tone light	+\$0
LU	soft white	+\$0
MT	medium tone	+\$0
CN	metallic champagne	+\$0

Step 5. End Panel Option

For 15½" high x 13" deep (1.)

SM	on module	+\$0
-----------	-----------	------

B-Style Storage/Display Shelf

E3232.

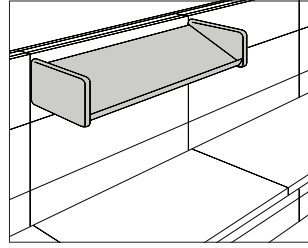

Specification Information

Step 1.

E3232.

Step 2. Width

- 24 24" wide
- 30 30" wide
- 36 36" wide
- 42 42" wide
- 48 48" wide

Prices for Steps 1-2.

E3232.	24	\$162
	30	\$170
	36	\$178
	42	\$190
	48	\$200

Step 3. Surface Finish

BU	black umber	+\$0
HF	inner tone light	+\$0
LU	soft white	+\$0
MT	medium tone	+\$0
CN	metallic champagne	+\$0

C-Style Flipper Door Unit

X3750.

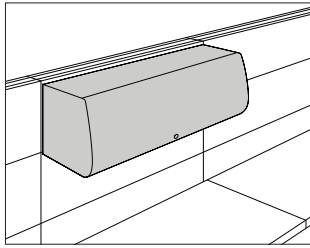

Specification Information

Step 1.

X3750.

Step 2. Width

24	24" wide
30	30" wide
36	36" wide
42	42" wide
48	48" wide

Step 3. Mechanism

SP	standard mechanism
-----------	--------------------

Step 4. Lift Handle

N	no lift handle
----------	----------------

Prices for Steps 1-4.

	N
X3750. 24 SP	\$618
30 SP	\$657
36 SP	\$697
42 SP	\$746
48 SP	\$800

Step 5. Lock Option

KA	keyed alike	-\$10
KD	keyed differently	+\$0

Step 6. Attachment Bracket

AO	for Action Office® system	+\$0
E1	for Ethospace® System	+\$0
F8	for Canvas	+\$0
OM	for Ethospace® off module	+\$0

Step 7. Case/Lift Handle Finish

8Q	folkstone grey	+\$0
91	white	+\$0
BU	black umber	+\$0
CN	metallic champagne	+\$0
EH	metallic bronze	+\$0
HF	inner tone light	+\$0
LT	light tone	+\$0
LU	soft white	+\$0
MT	medium tone	+\$0
WL	sandstone	+\$0
WN	warm grey neutral	+\$0

Step 8. Door Finish

For Action Office® system (AO), Ethospace® System (E1), Canvas (F8), or Ethospace® off module (OM)

8Q	folkstone grey	+\$0
91	white	+\$0
BU	black umber	+\$0
CN	metallic champagne	+\$0
EH	metallic bronze	+\$0
HF	inner tone light	+\$0
LT	light tone	+\$0
LU	soft white	+\$0
MT	medium tone	+\$0
WL	sandstone	+\$0
WN	warm grey neutral	+\$0

Ethospace® Storage

C-Style Flipper Door

X3710.

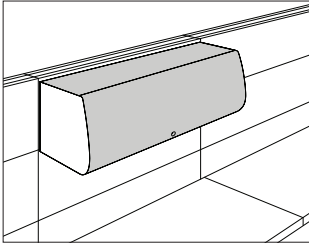

Ethospace® Storage

Specification Information

Step 1.
X3710.

Step 2. Width

- 24SP** 24" wide
- 30SP** 30" wide
- 36SP** 36" wide
- 42SP** 42" wide
- 48SP** 48" wide

Step 3. Lift Handle

- N** no lift handle

Prices for Steps 1-3.

	N
X3710. 24SP	\$386
30SP	\$412
36SP	\$450
42SP	\$486
48SP	\$520

Step 4. Lock Option

- KA** keyed alike -\$10
- KD** keyed differently +\$0

Step 5. Top/Lift Handle Finish

- 8Q** folkstone grey +\$0
- 91** white +\$0
- BU** black umber +\$0
- EH** metallic bronze +\$0
- HF** inner tone light +\$0
- LT** light tone +\$0
- LU** soft white +\$0
- MT** medium tone +\$0
- WL** sandstone +\$0
- WN** warm grey neutral +\$0

Step 6. Door Finish

- 8Q** folkstone grey +\$0
- 91** white +\$0
- BU** black umber +\$0
- EH** metallic bronze +\$0
- HF** inner tone light +\$0
- LT** light tone +\$0
- LU** soft white +\$0
- MT** medium tone +\$0
- WL** sandstone +\$0
- WN** warm grey neutral +\$0

C-Style Shelf

X3730.

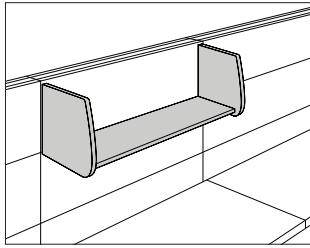

Specification Information

Step 1.

X3730.

Step 2. Width

24	24" wide
30	30" wide
36	36" wide
42	42" wide
48	48" wide

Prices for Steps 1-2.

X3730. 24	\$254
30	\$263
36	\$276
42	\$292
48	\$305

Step 3. Attachment Bracket

AO	for Action Office® system	+\$0
E1	for Ethospace® System	+\$0
F8	for Canvas	+\$0
OM	for Ethospace® off module	+\$0

Step 4. Surface Finish

8Q	folkstone grey	+\$0
91	white	+\$0
BU	black umber	+\$0
HF	inner tone light	+\$0
LT	light tone	+\$0
MT	medium tone	+\$0
EH	metallic bronze	+\$0
CN	metallic champagne	+\$0
WL	sandstone	+\$0
LU	soft white	+\$0
WN	warm grey neutral	+\$0

E-Style Flipper Door Unit

E3110.

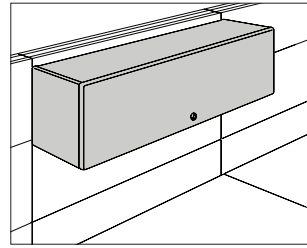

Specification Information

Step 1.

E3110.

Step 2. Width

24	24" wide
30	30" wide
36	36" wide
42	42" wide
48	48" wide

Step 3. Door Material

F	fabric door
----------	-------------

Prices for Steps 1-3.

	F
E3110. 24	\$554
30	\$597
36	\$643
42	\$683
48	\$727

Step 4. Lock Option

KA	keyed alike	-\$10
KD	keyed differently	+\$0

Step 5. Case Finish

BU	black umber	+\$0
HF	inner tone light	+\$0
LU	soft white	+\$0
MT	medium tone	+\$0
CN	metallic champagne	+\$0

Step 6. End Panel Option

SM	for Ethospace® on module	+\$0
-----------	--------------------------	------

Step 7. Door Finish

See application chart and textiles list for fabric usage and numbers.
First 2 digits of number indicate fabric line; remaining digit(s) indicate fabric color.

Price Category 1	+\$0
Price Category 2	+\$18
Price Category 3	+\$37
Price Category 4	+\$54

E-Style Flipper Door

E9002.

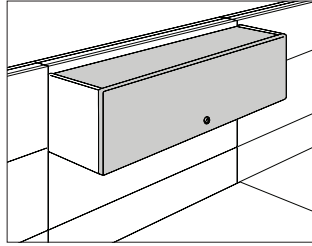

Specification Information

Step 1.

E9002.

Step 2. Width

24	24" wide
30	30" wide
36	36" wide
42	42" wide
48	48" wide

Step 3. Door Material

F fabric door

Prices for Steps 1-3.

	F
E9002. 24	\$335
30	\$364
36	\$390
42	\$413
48	\$441

Step 4. Lock Option

KA	keyed alike	-\$10
KD	keyed differently	+\$0

Step 5. Top Finish

BU	black umber	+\$0
HF	inner tone light	+\$0
LU	soft white	+\$0
MT	medium tone	+\$0
CN	metallic champagne	+\$0

Step 6. Door Finish

See application chart and textiles list for fabric usage and numbers. First 2 digits of number indicate fabric line; remaining digit(s) indicate fabric color.

Price Category 1	+\$0
Price Category 2	+\$18
Price Category 3	+\$37
Price Category 4	+\$54

E-Style Shelf

E3130.
E3133.

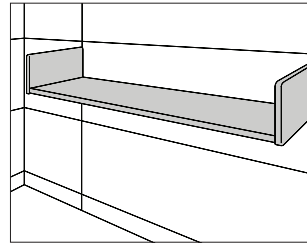

Specification Information

Step 1.

E313

Step 2. Height/Depth

0.	7 ¹ / ₂ " high x 13 ¹ / ₄ " deep
3.	15 ¹ / ₂ " high x 13 ¹ / ₂ " deep

Step 3. Width

24	24" wide
30	30" wide
36	36" wide
42	42" wide
48	48" wide

Prices for Steps 1-3.

E3130. 24	\$216
30	\$232
36	\$247
42	\$260
48	\$270
<hr/>	
E3133. 24	\$251
30	\$272
36	\$291
42	\$312
48	\$328

Step 4. Surface Finish

BU	black umber	+\$0
HF	inner tone light	+\$0
LU	soft white	+\$0
MT	medium tone	+\$0
CN	metallic champagne	+\$0

Step 5. End Panel Option

For 15¹/₂" high x 13¹/₂" deep (3.)

SM	on module	+\$0
-----------	-----------	------

F-Style Sliding Door Storage Unit E3810.

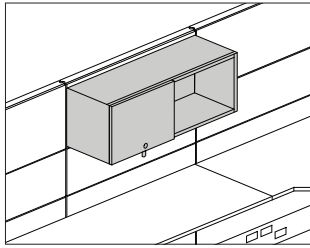

Specification Information

Step 1.

E3810.

Step 2. Height

1 15" high

Step 3. Width

24 24" wide

30 30" wide

36 36" wide

42 42" wide

48 48" wide

Step 4. Door Material

P painted door

Step 5. Lock

N no lock

L lock

Prices for Steps 1-5.

	PN	PL
E3810. 1 24	\$371	384
30	\$394	405
36	\$425	436
42	\$458	469
48	\$485	496

Step 6. Lock Option

For lock (L)

KA keyed alike	-\$10
KD keyed differently, black	+\$0

Step 7. Case Finish

BU black umber	+\$0
HF inner tone light	+\$0
LU soft white	+\$0
MT medium tone	+\$0
CN metallic champagne	+\$0

Step 8. Door Finish

BU black umber	+\$0
HF inner tone light	+\$0
LU soft white	+\$0
MT medium tone	+\$0
CN metallic champagne	+\$0

Step 9. Pull Finish

CL cool grey neutral	+\$0
WN warm grey neutral	+\$0

F-Style Upmount Sliding Door Storage Unit

E3814.

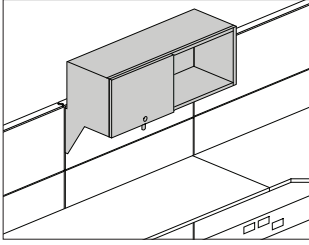

Ethospace® Storage

Specification Information

Step 1.
E3814.

Step 2. Width

- 24** 24" wide
- 30** 30" wide
- 36** 36" wide
- 42** 42" wide
- 48** 48" wide

Step 3. Door Material

- P** painted door

Step 4. Lock

- N** no lock
- L** lock

Prices for Steps 1-4.

	N	L
E3814. 24 P	\$572	583
30 P	\$610	621
36 P	\$649	662
42 P	\$691	703
48 P	\$732	744

Step 5. Lock Option

For lock (L)

- KA** keyed alike -\$10
- KD** keyed differently, black +\$0

Step 6. Case Finish

- BU** black umber +\$0
- HF** inner tone light +\$0
- LU** soft white +\$0
- MT** medium tone +\$0
- CN** metallic champagne +\$0

Step 7. Door Finish

- BU** black umber +\$0
- HF** inner tone light +\$0
- LU** soft white +\$0
- MT** medium tone +\$0
- CN** metallic champagne +\$0

Step 8. Pull Finish

- CL** cool grey neutral +\$0
- WN** warm grey neutral +\$0

F-Style Shelf

E3811.

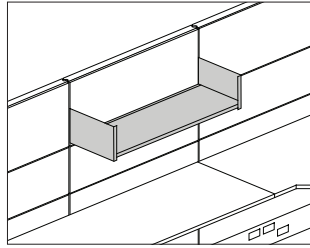

Specification Information

Step 1.

E3811.

Step 2. Width

24	24" wide
30	30" wide
36	36" wide
42	42" wide
48	48" wide

Prices for Steps 1-2.

E3811. 24	\$141
30	\$149
36	\$159
42	\$169
48	\$177

Step 3. Surface Finish

BU	black umber	+\$0
HF	inner tone light	+\$0
LU	soft white	+\$0
MT	medium tone	+\$0
CN	metallic champagne	+\$0

F-Style Storage Unit Back Panel

E3812.

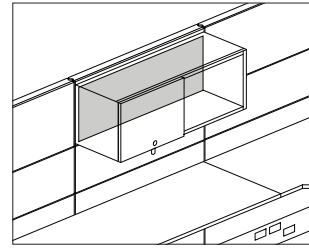

Specification Information

Step 1.

E3812.

Step 2. Height

15	15" high
-----------	----------

Step 3. Width

24	24" wide
30	30" wide
36	36" wide
42	42" wide
48	48" wide

Prices for Steps 1-3.

	24	30	36	42	48
E3812. 15	\$124	128	136	146	155

Step 4. Surface Finish

8Q	folkstone grey	+\$0
91	white	+\$0
BU	black umber	+\$0
HF	inner tone light	+\$0
LU	soft white	+\$0
MT	medium tone	+\$0
SG	slate grey	+\$0
WL	sandstone	+\$0
CN	metallic champagne	+\$0
EH	metallic bronze	+\$0
MS	metallic silver	+\$0

Ethospace® Storage

Component Brace

X3910.

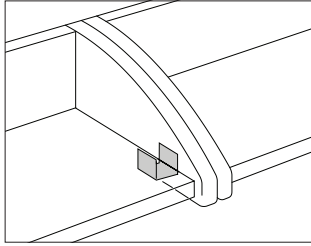

Specification Information

Step 1.

X3910.

Step 2. Usage

- 1** for C-/E-style flipper unit/shelf
- 2** for utility shelf (E3234.)

Prices for Steps 1-2.

X3910. 1	\$45
2	\$45

Step 3. Surface Finish

For C-/E-style flipper unit/shelf (1)

98 studio white	+\$0
BU black umber	+\$0

Shelf Divider, Angled

G7330.

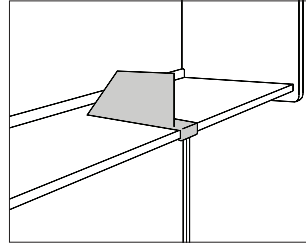

Specification Information

Step 1.

G7330.

\$255

Step 2. Surface Finish

8Q folkstone grey	+\$0
91 white	+\$0
BU black umber	+\$0
HF inner tone light	+\$0
LT light tone	+\$0
LU soft white	+\$0
MT medium tone	+\$0
SG slate grey	+\$0
WL sandstone	+\$0
WN warm grey neutral	+\$0
CN metallic champagne	+\$0
EH metallic bronze	+\$0

Coat Hook

E3922.

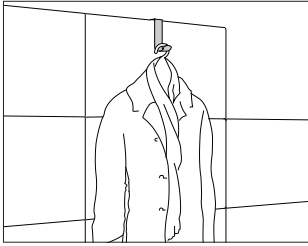

Specification Information

Step 1.

E3922. \$73

Step 2. Finish

BU black umber +\$0

HF inner tone light +\$0

Energy-Efficient Task Light

G6120.
G6121.
G6123.

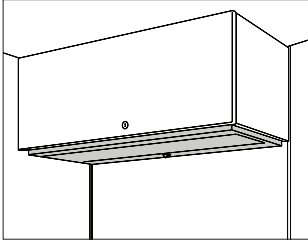

Ethospace® Lighting

Specification Information

Step 1.

G612

Step 2. Code Requirements

- 0. meets local codes including Canada
- 1. meets Chicago codes
- 3. meets New York City codes

Step 3. Width

24	24" wide
30	30" wide
36	36" wide
42	42" wide
48	48" wide
60	60" wide

Step 4. Dimmer

For 24" wide (24)

N no dimmer

For 30" wide (30), 36" wide (36), 42" wide (42), 48" wide (48), or 60" wide (60)

N no dimmer

D 3-step dimmer

Step 5. Bracket Option

S for Action Office® or Ethospace® Systems or Canvas

Q for C-style storage or E3234.

P for Passage® Desking System

Prices for Steps 1-5.

	S	Q	P
G6120. 24 N	\$333	333	333
30 N	\$345	345	345
D	\$379	379	379
36 N	\$354	354	354
D	\$389	389	389
42 N	\$370	370	370
D	\$404	404	404
48 N	\$377	377	377
D	\$414	414	414
60 N	\$411	411	411
D	\$454	454	454

	S	Q	P
G6121. 24 N	\$382	382	382
30 N	\$400	400	400
D	\$435	435	435
36 N	\$407	407	407
D	\$450	450	450
42 N	\$420	420	420
D	\$462	462	462
48 N	\$428	428	428
D	\$469	469	469
60 N	\$467	467	467
D	\$514	514	514

	S	Q	P
G6123. 24 N	\$330	330	330
30 N	\$358	358	358
D	\$396	396	396
36 N	\$368	368	368
D	\$403	403	403
42 N	\$377	377	377
D	\$414	414	414
48 N	\$388	388	388
D	\$426	426	426
60 N	\$426	426	426
D	\$467	467	467

Step 6. Surface Finish

For Action Office® or Ethospace® Systems or Canvas (S) or C-style storage or E3234. (Q)

8Q	folkstone grey	+\$0
91	white	+\$0
BU	black umber	+\$0
CL	cool grey neutral	+\$0
EH	metallic bronze	+\$0
HF	inner tone light	+\$0
LT	light tone	+\$0
LU	soft white	+\$0
MT	medium tone	+\$0
WL	sandstone	+\$0
WN	warm grey neutral	+\$0

For Passage® Desking System (P)

BU	black umber	+\$0
-----------	-------------	------

Utility Task Light

G6136.
G6137.

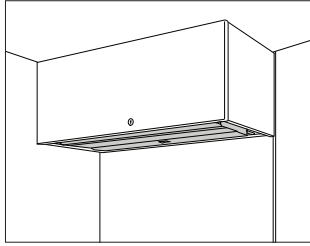

Specification Information

Step 1.

G613

Step 2. Code Requirements

- 6. meets local codes including Canada and New York City
- 7. meets Chicago codes

Step 3. Width

- 24** 24" wide
- 30** 30" wide
- 42** 42" wide
- 60** 60" wide

Step 4. Attachment Bracket

- S** for Action Office® or Ethospace® Systems or Canvas
- Q** for C-style storage or E3234.
- P** for Passage® Desking System
- F** for 5000 Series Furniture
- T** for transaction surface/counter top/wood cabinets

Prices for Steps 1-4.

	S	Q	P	F	T
G6136. 24	\$246	246	246	246	246
30	\$250	250	250	250	250
42	\$274	274	274	274	274
60	\$305	305	305	305	305
G6137. 24	\$330	330	330	330	330
30	\$334	334	334	334	334
42	\$358	358	358	358	358
60	\$392	392	392	392	392

Flute™ Personal Light

Y6470.

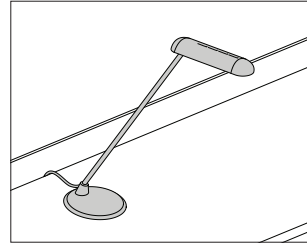

Specification Information

Step 1.

Y6470.

Step 2. Attachment Bracket

- CM** surface clamp
- FR** freestanding

Prices for Steps 1-2.

Y6470. CM	\$329
FR	\$329

Step 3. Finish

91 white	+\$0
G2 graphite satin	+\$0
MS metallic silver	+\$0

Ethospace® Lighting

Index by Product Name

Ethospace® System 10-Day or Less	
	page(s)
2-Way 90° Connector	13
2-Way 90° Connector Cover	21
2-Way 90° Connector Cover, Architectural	22
2-Way 90° Connector Cover, Monolithic	22
2-Way 90° Connector, Monolithic	14
2-Way 90° Stacking Connector	18
3-Way 90° Connector	16
3-Way 90° Connector Cover	25
3-Way 90° Connector Cover, Monolithic	25
3-Way 90° Connector, Monolithic	17
3-Way 90° Stacking Connector	19
4-Way 90° Connector	17
4-Way 90° Stacking Connector	19
Acoustical Tile	39
Architectural Cladding, Fabric	39
B-Style Flipper Door	59
B-Style Flipper Door Unit	58
B-Style Shelf	60
B-Style Storage/Display Shelf	60
Bare Connector	20
Bare Frame	5
Base Power Entry, Junction Box, 4 Circuit	29
Baseline Box Assembly, H-Style Frame	33
Baseline Harness, 4 Circuit	30
Beltline Bezel, H-Style Frame	36
Beltline Harness, 4 Circuit	31
C-Style Flipper Door	62
C-Style Flipper Door Unit	61
C-Style Shelf	63
Cable Access Tile	40
Cable Channel Tile	41
Cable Manager, Extra Capacity	35
Ceiling Power Entry, Internal Direct Connect	29
Coat Hook	69
Communication Port Faceplate Extender	36
Communication Port Faceplate Reducer	35
Component Brace	68
Concave Corner Surface	48
Connector Top Cap	27
Connect™-S300	34
Cord Cleat	55
Corner Surface	47
Curvilinear Surface	45
Draw Rod	9
E-Style Flipper Door	64

E-Style Flipper Door Unit	63
E-Style Shelf	64
Energy-Efficient Task Light	70
Extended Corner Surface, Rectangular End	50
F-Style Shelf	67
F-Style Sliding Door Storage Unit	65
F-Style Storage Unit Back Panel	67
F-Style Upmount Sliding Door Storage Unit	66
Face Tile	37
Finished End	26
Finished End, Change of Height	26
Floor-Length Face Tile	38
Flute™ Personal Light	71
Frame	5
Frame Top Cap	27
Frame, Transaction Work Surface	7
Open Tile	41
Open Tile, Squared Stile	42
Oval Transaction Surface	56
Pass-Through Harness, Connector	31
Pass-Through Harness, Frame	30
Perforated Tile, Squares	42
Power Entry, External Direct Connect, 4 Circuit	28
Power Entry, Internal Direct Connect, 4 Circuit	28
Power Jumper, 4 Circuit	32
Rail Tile	43
Receptacle, 4 Circuit, 15 Amp	33
Rectangular Surface	44
Shelf Divider, Angled	68
Side Cover	8
Spacer	14
Spacer Connector Cover	23
Spacer Connector Cover, Monolithic	24
Spacer Stacking Connector	18
Spacer/3-Way 90° Connector Cover, Architectural	24
Squared-Edge Corner Wedge	51
Squared-Edge Transaction Surface, Rectangular End	56
Stacking Frame	9
Stacking Frame Hardware Kit, Change of Height	20
Stiffener	55
Stile Covers and Top Caps, Transaction Work Surface Frame	7
Surface Ganging Bracket	53
Tackable Tile	40
Tile-Height Harness, 4 Circuit	32
Tile Adapter	10
Tool Bar	43

Index by Product Name *continued*

Index: Product Name

Trim Strip	11
Utility Task Light	71
Wall Fastener	11
Wall Start	12
Wall Start Filler	12
Wall Strip	10
Work Surface Support Bracket	53
Work Surface Support Panel, End, Glides	54
Work Surface Support Panel, Mid-Run, Glides	54
Work Surface Support, Single	52

Index by Product Number

E1109. Bare Frame	page(s) 5	E1354. Baseline Harness, 4 Circuit	30
E1109. Frame	5	E1355.	
E1112. Stacking Frame	9	E1356. Pass-Through Harness, Connector	31
E1116. Frame, Transaction Work Surface	7	E1357. Tile-Height Harness, 4 Circuit	32
E1117. Stile Covers and Top Caps, Transaction Work Surface Frame	7	E1396. Cable Manager, Extra Capacity	35
E1120. Draw Rod	9	E1420. Face Tile	37
E1130. Wall Strip	10	E1420. Floor-Length Face Tile	38
E1131. Tile Adapter	10	E1422. Tackable Tile	40
E1132. Trim Strip	11	E1423. Acoustical Tile	39
E1210. Wall Start	12	E1425. Rail Tile	43
E1212. Wall Start Filler	12	E1433. Cable Channel Tile	41
E1219. Bare Connector	20	E1436. Cable Access Tile	40
E1220. 2-Way 90° Connector	13	E1440. Open Tile	41
E1220. 2-Way 90° Stacking Connector	18	E1441. Perforated Tile, Squares	42
E1222. Spacer	14	E1444. Open Tile, Squared Stile	42
E1222. Spacer Stacking Connector	18	E1445. Architectural Cladding, Fabric	39
E1224. 2-Way 90° Connector, Monolithic	14	E2290. Work Surface Support Panel, End, Glides	54
E1230. 3-Way 90° Connector	16	E2291. Work Surface Support Panel, Mid-Run, Glides	54
E1230. 3-Way 90° Stacking Connector	19	E2393. Work Surface Support, Single	52
E1231. 3-Way 90° Connector, Monolithic	17	E2810. Oval Transaction Surface	56
E1240. 4-Way 90° Connector	17	E2812. Squared-Edge Transaction Surface, Rectangular End	56
E1240. 4-Way 90° Stacking Connector	19	E2931. Work Surface Support Bracket	53
E1250. Finished End	26	E3110. E-Style Flipper Door Unit	63
E1251. Finished End, Change of Height	26	E3130. E-Style Shelf	64
E1260. Frame Top Cap	27	E3133.	
E1261. Connector Top Cap	27	E3212. B-Style Flipper Door Unit	58
E1263. Side Cover	8	E3217. B-Style Flipper Door	59
E1264.		E3230. B-Style Shelf	60
E1270. 2-Way 90° Connector Cover	21	E3231.	
E1271. Spacer Connector Cover	23	E3232. B-Style Storage/Display Shelf	60
E1272. 3-Way 90° Connector Cover	25	E3610. Tool Bar	43
E1274. 2-Way 90° Connector Cover, Monolithic	22	E3810. F-Style Sliding Door Storage Unit	65
E1275. Spacer Connector Cover, Monolithic	24	E3811. F-Style Shelf	67
E1276. 3-Way 90° Connector Cover, Monolithic	25	E3812. F-Style Storage Unit Back Panel	67
E1281. 2-Way 90° Connector Cover, Architectural	22	E3814. F-Style Upmount Sliding Door Storage Unit	66
E1282. Spacer/3-Way 90° Connector Cover, Architectural	24	E3922. Coat Hook	69
E1293. Stacking Frame Hardware Kit, Change of Height	20	E9002. E-Style Flipper Door	64
E1294.		EW400. Baseline Box Assembly, H-Style Frame	33
E1311. Receptacle, 4 Circuit, 15 Amp	33	EWS10. Rectangular Surface	44
E1322. Power Entry, External Direct Connect, 4 Circuit	28	EWS12. Curvilinear Surface	45
E1323. Base Power Entry, Junction Box, 4 Circuit	29	EWS20. Corner Surface	47
E1325. Power Entry, Internal Direct Connect, 4 Circuit	28	EWS21. Concave Corner Surface	48
E1331. Ceiling Power Entry, Internal Direct Connect	29	EWS22. Extended Corner Surface, Rectangular End	50
E1341. Power Jumper, 4 Circuit	32	FT29B. Surface Ganging Bracket	53
E1342. Pass-Through Harness, Frame	30	FV696. Stiffener	55
E1353. Beltline Harness, 4 Circuit	31	G1189. Communication Port Faceplate Extender	36

Index by Product Number *continued*

Index: Product Number

G1189. Communication Port Faceplate Reducer	35
G1331. Cord Cleat	55
G1510. Beltline Bezel, H-Style Frame	36
G6120. Energy-Efficient Task Light	70
G6121.	
G6123.	
G6136. Utility Task Light	71
G6137.	
G7330. Shelf Divider, Angled	68
X1192. Wall Fastener	11
X3710. C-Style Flipper Door	62
X3730. C-Style Shelf	63
X3750. C-Style Flipper Door Unit	61
X3910. Component Brace	68
Y1323. Connect™-S300	34
Y2091. Squared-Edge Corner Wedge	51
Y6470. Flute™ Personal Light	71

10-Day or Less Order Information

10-Day or Less Program

10-day or less products are designed for established Herman Miller dealers with pre-approved credit.

Products are distributed from multiple West Michigan manufacturing facilities. These include Holland, Spring Lake, and Zeeland. Orders will be shipped within 10 business days or less from the date of Herman Miller acknowledgement.

Ordering Procedures

1. Please place orders through Order Manager. If this is not available to you, place orders through mail or fax. Verbal purchase orders will not be accepted.
Order Entry fax number for Passage®, 5000 Series, and Meridian® Filing and Storage: (616) 846 9236.
Order Entry fax number for all other products: (616) 654 3085.
2. Orders must be clearly marked “10-day or less program” and include only 10-day or less products. Orders not marked this way will be processed under standard lead times. Orders for standard lead times must be placed on a separate purchase order.
3. Only fabrics and finishes listed with each product are available through the 10-day or less program.
4. For any 10-day or less project over \$250,000 list price, please contact your Customer Care representative within 48 hours of order entry to reserve lead time.
5. For more information, contact your Customer Care representative at: (866) 854 3048 EXT 3400.

Shipments and Delivery

Per Herman Miller Terms and Conditions.

Changes and Cancellation

Per Herman Miller Terms and Conditions.



10-Day Keyed-Alike Information

Keyed-Alike Locks

All components with locks may be specified keyed alike. Products with keyed-alike locks will be shipped with lock chassis installed. Installation of lock cylinders will be on-site according to instructions provided. Herman Miller, Inc. will not be responsible for lock cylinder installation.

When specifying product keyed-alike, include separate lines on your order for the lock cylinders.

For Action Office®, Ethospace®, or Passage® products, list cylinder part number and key number (232092-XXX); select a key number (or numbers) between 226 and 427, excluding numbers 408 and 412.

For Tu® Storage, Meridian® Storage, or 5000 Series, see the following charts.

Keyed-alike locks are field installed.

To order keyed-alike locks for Action Office® Series 1 and 2 door panels, please contact Customer Care.

A master key can be used to open any lock on an attached or freestanding component. In addition, a removal key or lock change tool is required to remove lock plugs. Customers interested in ordering master keys, removal keys, or lock change tools should contact Customer Care.

For Tu Storage, Meridian Storage, or 5000 Series desk components with pedestals, specify as follows:

Specification Code	Key Number	Color	Lock Series
KA	232092-XXX ¹	black	UM series 226-427
KA	1B2JK7-XXX ¹	chrome	UM series 226-427

For 5000 Series flipper door unit with bezel or credenza storage cabinet with bezel, specify as follows:

Specification Code	Key Number	Color	Lock Series
KA	232092-XXX ¹	black	UM series 226-427

Key Number:

XXX¹ = a key number between 226 and 427 (excluding 408 and 412)



Proprietary Textiles Application Chart – 10-Day Workspaces

- Available

Application Note: Herman Miller cannot guarantee material/pattern alignment in adjacent products. For example, a fabric's pattern may not align from one screen to the next, or from one panel to the next.

	Action Office® Panels/Connectors	B-Style Storage	B-Style Tackboards	E-Style Storage	Ethospace® Tiles/Connectors	Ethospace Attaching Screens	Canvas Office Landscape® Tiles	Resolve® Boundary Screens	5000 Series Storage and Tackboards	Seating
Price Category 1										
8A__ Bubbletack								•		
2V__ Chain	•	•	•	•	•		22		3	
8T__ Crossing (85__)	5	2	2	•			•		3	6
95__ Gem	2	2	2	•	•		•		3	•
2I__ Grasscloth	•	•	•	•	•		•		3	
1MN__ Monologue	2	2	2	•	•		•			•
8B__ Multiscrim™						•		•		
5T__ Resonance	•	•	•	•	•		•		3	
8C__ Scrim Trim								•		
2M__ Silkworm	•	•	•	•	•		•		3	
22F__ Slant	10		•		•		•		3	
235__ Tailored	•	•		•	•		•			•
1WS__ Whisper	2	2	2	•	•		•			•
Price Category 2										
1CD__ Code	•	•	•	•	•		•			
51__ Cord	•	•	•	•	•		•		3	
92__ Crepe	2	•	•	•	•		•		3	•
57__ Frost	•	•	•	•	•		•		3	
84__ Grosgrain	5			•	•		•		3	
4N__ Horizon	2	2	2	•	•		•		3	
1LM__ Loom	2	2	2	•	•		•			
3A__ Moiré		2	2	•	•		22		3	
1RV__ Rivet	2	2	2	•	•		•			•
8R__ Twist (5S__)	4	2	2	•	•		•		3	6
Price Category 3										
70__ Bento	2	2	2	•			•		3	•
1FB__ Connection	•	•	•	•	•		•		3	
1FC__ Current	•	•	•	•	•		•		3	
8Z__ Glaze	•	•	•	•	•		•		3	
47__ Ground Cloth®	•	•	•	•	•		•		3	
5D__ Kira 2	2	2	2	•	•		•		3	
8L__ Savannah	•	20	•	•	•		•	•		
8W__ Strands	•	•	•	•	•		•		3	
Price Category 4										
6S__ Quilty	2	2	2	•	•		•		3	•
63__ Sironetta	•	•	•	•	•		•		3	

- 2 Available on all products except 54" and 60" wide.
- 3 Fabric is railroaded for all widths.
- 4 Not available on Action Office acoustical panels and not available on 54" and 60" wide products.
- 5 Not available on Action Office acoustical panels.
- 6 Available on seating products in select colors. See the "Proprietary Textile Colors-10-Day Seating" appendix.

- 10 Not available on Action Office connectors, cable management, and spacers.
- 20 Available only on Ethospace B-Style.
- 22 Not available as railroaded application option for Chain (2V__) and Moiré (3A__).



Proprietary Textile Colors – 10-Day Workspaces

Price Category 1

Bubbletack	
100% polyester	
8A01	Seashell White
8A02	Pearl Grey
8A07	Pebble Beige
8A19	Spa Blue

Chain	
66" wide	
100% recycled polyester	
2V01	Pearl
2V02	Oyster
2V03	Wheat
2V04	Linen
2V05	Wicker
2V06	Bamboo
2V07	Sage
2V08	Spring Wood
2V09	Iceberg

Crossing	
54" wide	
86% antimony-free polyester	
14% polyester	
8T03	Wicker
8T04	Porcelain
8T05	Warm Grey
8T06	Sepia
8T07	Pumpkin
8T08	Copper
8T09	Cranberry
8T10	Tomato
8T11	Mulberry
8T12	Plum
8T13	Green Apple
8T14	Loden
8T15	Spruce
8T16	Periwinkle
8T17	Cerulean
8T18	Indigo
8T19	Shale
8T20	Brownstone
8T21	Bark
8T22	Tin
8T23	Graphite
8T24	Black

Crossing	
For systems products only.	
54" wide	
86% antimony-free polyester	
14% polyester	
8501	Ivory
8502	Oyster

Gem	
54" wide	
100% antimony-free polyester	
9501	Sesame
9502	Tangerine
9503	Red
9510	Berry Blue
9512	Green Apple
9514	Black
9515	Slate Grey
9516	Fog

Grasscloth	
66" wide	
100% recycled polyester	
2I01	Silver Birch
2I02	Pampas
2I03	Sedge
2I07	Lea
2I08	Taro
2I09	Steam Grey
2I10	Cayenne
2I11	Bottle Green
2I12	Surf
2I13	Gravel

Monologue	
54" wide	
56% recycled polyester	
44% polyester	
1MN01	Linen
1MN02	Alabaster
1MN03	Truffle
1MN04	Folkstone
1MN05	Silver Pine
1MN06	Slate
1MN07	Seed
1MN08	Yellow Oxide
1MN09	Persimmon
1MN10	Tundra
1MN11	Meadow
1MN12	Blue Sky
1MN13	Blue Spruce
1MN14	Deep Sea

Multiscrim™	
60" wide	
100% polyester	
8B01	Seashell White
8B02	Pearl Grey
8B07	Pebble Beige
8B19	Spa Blue

Resonance	
66" wide	
100% polyester	
5T04	Greige
5T05	Porcelain
5T06	Alabaster
5T15	Iris
5T28	Sugar
5T54	Saltbush

Scrim Trim	
61" wide	
82% polyester	
18% spandex	
8C01	Seashell White
8C02	Pearl Grey

Tailored	
Assigned lead-time textile. A	
54" wide	
56% polyester	
44% recycled polyester	
23501	Studio White
23502	Sugar
23503	Tomato
23504	Orchid
23505	Boysenberry
23506	Chive
23507	Bluegrass
23508	Cobalt
23509	Cadet
23510	Fog
23511	Graphite
23512	Black
23513	Coffee

Silkworm	
66" wide	
58% recycled polyester	
42% polyester	
2M01	Cocoon
2M02	Pongee
2M03	Saffron
2M04	Tussah
2M05	Ceylon
2M06	Jasmine
2M07	Shale
2M08	Monsoon

Price Category 1 continued on next page

Proprietary Textile Colors – 10-Day Workspaces

continued

Price Category 1

continued

Slant
66" wide
51% polyester
49% recycled polyester
22F01 Beech Nut
22F02 Chamois
22F03 Chartreuse
22F04 Pesto
22F05 Peacock
22F06 Neptune
22F07 Blueberry
22F08 Boysenberry
22F09 Magenta
22F10 Pumpkin
22F11 Cranberry
22F12 Silver Birch
22F13 Blue Stone
22F14 Truffle
22F15 Shale

Whisper
54" wide
73% recycled polyester
27% polyester
1WS01 Sand Dollar
1WS02 Pebble
1WS03 Silver Birch
1WS04 Iceberg
1WS05 Silver Pine
1WS06 Carbon
1WS07 Cumin
1WS08 Adobe
1WS09 Strawberry
1WS10 Blush
1WS11 Eggplant
1WS12 Willow
1WS13 Sea Grass
1WS14 Pool
1WS15 Blueberry

Price Category 2

Code
66" wide
100% Repreve recycled polyester
1CD01 Linen
1CD02 Khaki
1CD04 Zinc
1CD05 Blue Black

Cord
66" wide
51% antimony-free polyester
49% polyester
5101 Ivory
5102 White Ash
5103 Linen
5104 Bamboo
5105 Sepia
5106 Wicker
5107 Sesame
5108 Kiwi Green
5109 Bayou
5110 Shade
5111 Spring Wood
5112 Summer White

Crepe
54" wide
100% recycled polyester
9201 Licorice
9203 Smoke
9209 Claret
9223 Cadet
9241 Beachglass
9243 Midnight
9244 Artichoke
9251 Fog
9252 Slate Grey
9260 Brownstone
9261 Shale
9262 Graphite
9263 Tomato
9264 Green Apple

Frost
66" wide
100% recycled polyester
5701 Bisque
5702 Abalone
5703 Porcelain
5704 Honey
5706 Sage
5710 Sable Grey

Grosgrain
66" wide
100% recycled polyester
8401 Pearl
8402 White Ash
8403 Warm Grey
8404 Khaki
8405 Oyster
8406 Celedon
8412 Tin

Horizon
54" wide
65% antimony-free polyester
35% polyester
4N01 Rye Grass
4N02 Sugar Pine
4N04 White Ash
4N05 Spring Wood
4N09 Oat Grass

Loom
54" wide
100% polyester
1LM01 Linen
1LM02 Brown Sugar and Spice
1LM03 Brick and Mortar
1LM04 Salt and Pepper
1LM07 Poppy
1LM09 Loden
1LM11 Deep Sea

Moiré
54" wide
100% recycled polyester
3A01 Concrete
3A03 Rattan
3A04 Chambray
3A12 Cork

Rivet
54" wide
100% recycled polyester
1RV01 Twig
1RV02 Deep Clay
1RV03 Woodrose
1RV04 Otter
1RV05 Hemlock
1RV06 Olive
1RV07 Lagoon
1RV08 Deep Sea
1RV09 Charcoal
1RV10 Grey Brindle

Twist
54" wide
80% antimony-free polyester
13% recycled polyester
7% polyester
8R05 Wicker
8R10 Poppy
8R14 Tin
8R15 Shale
8R16 Graphite
8R17 Birch
8R18 Sepia
8R22 Blueberry
8R23 Green Apple
8R26 Gunmetal
8R28 Citrus
8R30 Tangerine
8R32 Wisteria
8R35 Waterfall
8R37 Carbon Dark

Price Category 2 continued on next page

Proprietary Textile Colors – 10-Day Workspaces

continued

Price Category 2

continued

Twist
For systems products only.
54" wide
80% antimony-free polyester
13% recycled polyester
7% polyester
5S01 Pearl
5S02 Ivory
5S03 Oyster

Price Category 3

Bento
54" wide
100% antimony-free polyester
7001 Frost
7003 Khaki
7004 Truffle

Connection
66" wide
100% antimony-free polyester
1FB1 Oyster
1FB2 Linen
1FB3 Iceberg
1FB4 Silver Pine
1FB9 Metal

Current
66" wide
100% antimony-free polyester
1FC1 Oyster
1FC2 Linen
1FC3 Iceberg
1FC4 Silver Pine
1FC9 Metal

Glaze
66" wide
100% recycled polyester
8Z01 Wicker
8Z03 Porcelain
8Z06 Rye
8Z07 Frost
8Z08 Silver Birch

Ground Cloth®
66" wide
100% polyester
4701 Vapor Grey
4721 Warm White
4722 Fog
4723 Straw
4724 Red Orange
4725 Wild Berry
4726 Green Apple
4727 Caribbean
4728 Midnight
4729 Cappuccino

Kira 2
54" wide
100% recycled polyester
5D13 Oasis
5D15 Ash
5D16 Falcon

Savannah
66" wide
76% recycled polyester
24% polypropylene
8L01 Pearl
8L07 Linen
8L10 Frost

Strands
66" wide
100% recycled polyester
8W01 Pebble
8W02 Porcelain
8W03 Taupe
8W05 Khaki
8W08 Tin

Price Category 4

Glisten
66" wide
84% polyester
16% recycled polyester
2X02 Rye
2X05 Iceberg
2X09 Pewter
2X10 Ash

Quilty
56" wide
100% antimony-free polyester
GreenShield
6S04 Straw
6S07 Brick
6S10 Mink
6S11 Green Apple
6S13 Indigo

Sironetta
66" wide
100% recycled polyester
6301 Acapella
6302 Sonata
6303 Interlude
6308 Harmony

For more information about our products and services or to see a list of dealers, please visit us at HermanMiller.com or call (800) 851 1196.

© 2018 Herman Miller, Inc., Zeeland, Michigan

® **HermanMiller**, 3D Intelligent, AO, Action Office, Aeron, ArcSpan, Aside, Avall, Avive, Bubble Lamps, Canvas Office Landscape, Caper, Celle, Co/Struc, Daisyone, Distil, Eames, Eco-Dematerialized, Embody, Envelop, Equa 2, Ergon 3, Ethospace, Exclave, Fine-Tune, FlexFront, Flo, Formcoat, Formwork, Ground Cloth, Herman Miller for the Home, Herman Miller for Healthcare, Intersect, Kinemat, Lapjack, Layout Studio, Lifework, Limerick, Live Unframed, Living Office, Locale, Maharam, Meridian, Mirra, Passage, Pellicle, Perspectives, PostureFit, Public Office Landscape, Resolve, Rodney, Sayl, Setu, Thrive, Tu, Wishbone, and Y-Tower are among the registered trademarks of Herman Miller, Inc., and its owned subsidiaries.

™ 8Z Pellicle, About Face, AireWeave, Albert, Backfit, Bubbletack, Burdick Group, Butterfly Back, Celeste, Cellular Suspension, Clam, Compass, Connect, Cubert, DOT, Duracare, Durawrap, Eames Soft Pad, EnhancedAccess, Everywhere, Flex-Edge, Flute, Harmonic, Herman Miller Select, Hopsak 2, Intent, Iota, Jaw, Keyless Entry, Keyn Chair Group by Herman Miller, Latitude, Locale, Logic Mini, Logic Power Access Solutions, Live OS, Loop, Lyris, Lyris 2, Made-to-Measure Storage, Metaform Portfolio, Mora, Motia, Multiscrim, Nelson, Pari, Pixelated Support, Plex, PostureFit SL, Prospect, Q, Renew, Sense, Soft Pad, Stackable, Stackable Storage, Striad, Swoop, Tone, TriFlex, Twist, Ubi, Verus and Wireframe are among the trademarks of Herman Miller, Inc., and its owned subsidiaries.

SM Herman Miller Options is among the service marks of Herman Miller, Inc.

Alexander Girard® is a registered trademark of The Alexander Girard Estate.

Chemsur® is a registered trademark of Wilsonart International.

Corian® is a registered trademark of E. I. du Pont de Nemours and Company Corporation.

Crypton® is a registered trademark of Crypton, Inc.

DACRON® is a registered trademark of INVISTA S.a r.l.

Edelman® Leather is a registered trademark of Edelman Leather, Inc.

FENIX NTM® is a registered trademark of Arpa Industriale S.p.A.

FLEXNET™ is a trademark of Milliken & Company.

Floor Saver Glide® is a registered trademark of Carpin Manufacturing, Inc.

Geiger® is a registered trademark, and Bumper™, Saiba™, and Ward Bennett™ are trademarks, of Geiger International.

Goetz™ is a trademark of Mark W. Goetz.

Hang-It-All® is a registered trademark of Lucia Eames Demetrios, d.b.a. Eames Office.

Holophane® is a registered trademark of Holophane.

Ingeo™ is a trademark of Cargill Dow LLC.

iPad® is a registered trademark of Apple, Inc.

LifeSize® is a registered trademark of LifeSize Communications, Inc.

Magis®, Bombo®, and Me Too® are registered trademarks of Magis S.p.A.

Microsoft® and Natural® Keyboard are registered trademarks of Microsoft Corporation.

Noguchi® and the Noguchi table configuration (trade dress) are registered trademarks, and Rudder Table™ is a trademark, of The Isamu Noguchi Foundation and Garden Museum.

Place Textiles® is a registered trademark of Place Textiles.

SuperSeat™ is a trademark of Dahti Seating, a division of ITW.